

SHORE SOLUTIONS INC.

DONNA MYERS
32 LINCOLN AVE.
MASSAPEQUA, N.Y. 11758
516-977-3102-FAX
516-816-4163
shoresolutions@aol.com

N. Y .S. Department of State
Division of Coastal Resources
One Commerce Plaza, Suite 1010
99 Washington Avenue
Albany, N.Y. 12231

April 6, 2021

RE: Peninsula Babylon LLC
Joseph Johns, President
191 Peninsula Drive
Babylon, NY 11702

Mailing address: 2631 Merrick Road
Bellmore, NY 11710

Dear Coastal Marine Specialist,

This property has had prior NYSDEC Permits for bulkhead replacement and minor dredging in 1996, NYSDEC ID 1-4720- 01581/00001. A subdivision of the property was approved by the NYSDEC in 2018. A NJ Letter was issued for this property in 2019. Enclosed please find an application that proposes:

5- 1-To reface an existing flush face bulkhead, board on board, raise the top of the bulkhead 1.8 feet to 3.9 foot elevation which is the recommended Town of Babylon Flood Plain Level Policy. A new top wale will be installed at the top of the bulkhead on the landward side of the proposed sheathing and new tie rods installed. New piles will be added along the bulkhead face at 10 feet on center to reinforce the bulkhead. The boat slip area and a 20' wide section just north of the boat slip will be dredged 10 feet seaward of the bulkhead to maintain a navigable depth.

6- In the boat slip, a 3' x 16' ramp and two 6' x 20' floats with four float anchor piles will be installed along the bulkhead. Three of these piles will be reset and one pile will be added. The purpose of the floats is for access to the moored 38' boat and for kayak use.

7- A 6' x 6' jet ski lift will be installed off of the bulkhead on one pile to the north of the slip.

8- To reconstruct the existing pier and to add a ramp, float and boat lift seaward of the existing pier to access navigable water. This property is located on the 450'+ wide mouth of Carl's River. The wide waterway can be seen in the Tidal Wetland Inventory Map Index 2 640-504. The existing pier has been in existence since the 1960's. We have supplied a Water Depth Survey prepared by a licensed surveyor to document the current water depths below MLLW. No dredging will be done around the pier or seaward of the pier. We propose to have a ramp extend off of the pier end that will lead to a float with a boat lift on the south side of the float and a mooring area for boarding the boat on the north side of the float. There will be 2 mooring piles installed on the north side of the float to keep the boat secure for boarding. The ramp, float and boat lift will be installed in adequate water depth. The mooring facility was designed according to the existing water depths and the owner's need to safely moor his 26' boat on the boat lift and the larger boat in the boat slip. This boat lift is needed since the site has high wave action due to a large fetch and a boat lift will help keep the boat safe during high wind and high wave events. The float and boat lift are reasonable and necessary at this site.

SHORE SOLUTIONS INC.

DONNA MYERS
32 LINCOLN AVE.
MASSAPEQUA, N.Y. 11758
516-977-3102-FAX
516-816-4163
shoresolutions@aol.com

N. Y .S. Department of State
Division of Coastal Resources
One Commerce Plaza, Suite 1010
99 Washington Avenue
Albany, N.Y. 12231

April 6, 2021

RE: Peninsula Babylon LLC
Joseph Johns, President
191 Peninsula Drive
Babylon, NY 11702

Continued:

This application was sent to the Army Corps of Engineers, Eastern Permit Section and the NYSDEC. The Coastal Policies affected are 2, 11, 12, 13, 14, 15, 16, 17, 21, 22, 30, 35, 38, 40, and 44. There will be no fill placed below Spring High Water. There will be minimal adverse impact to the marine environment. The shading will be minimal and a variety of marine plant life and animals, such as seaweed and barnacles, will attach to the proposed piles enhancing marine life food production.. The existing bottom is sandy and there is no marine vegetation present. There are no marked channels near the proposed location of the pier, ramp and float. There will be no interference with navigation; boats do not navigate near this shore. This project is consistent with the following policies:

Policy #2. Facilitate the siting of water dependent uses and facilities on or adjacent to coastal waters. Refacing the bulkhead will allow it to remain functional as an erosion control structure that will protect the upland property. The proposed pier configuration is needed to access the navigable water and safely moor a boat in order to access coastal waters. This pier, ramp and float were designed using the current water depth survey to be a modest pier proposing only what is necessary to reach the navigable water. It extends out to -4' of water so the boat can be moored in navigable water. The proposed pier configuration is consistent with this policy.

Policy 11 Buildings and other structures will be sited in the coastal area so as to minimize damage to property and the endangering of human lives caused by flooding and erosion. Refacing the bulkhead will allow it to remain functional as an erosion control structure that will protect the upland property. The proposed seaward extension of the pier configuration is consistent with this policy and is necessary to access the navigable water. It will be built to withstand hurricanes and will not cause erosion. The proposed project is consistent with this policy.

Policy 12 Activities or development in the coastal area will be undertaken so as to minimize damage to natural resources and property from flooding and erosion by protecting natural protective features including beaches, dunes, barrier islands and bluffs. Refacing the bulkhead will allow it to remain functional as an erosion control structure that will protect the upland property. The pier configuration is consistent will not cause erosion. The project is consistent with this policy.

Policy 15 Mining, excavation or dredging in coastal waters shall not significantly interfere with the natural coastal processes which supply beach materials to land adjacent to such waters and shall be undertaken in a manner which will not cause an increase in erosion of such land. The proposed dredging is minor and is located in the existing boat slip to maintain a navigable depth and a small 10' x 20' area on the north side of the boat slip. A 20' wide area by 10' seaward will be dredged along the bulkhead to maintain a navigable depth and allow the jet ski lift to operate. This dredging will not cause erosion. The proposed dredging is consistent with this policy.

SHORE SOLUTIONS INC.

DONNA MYERS
32 LINCOLN AVE.
MASSAPEQUA, N.Y. 11758
516-977-3102-FAX
516-816-4163
shoresolutions@aol.com

N. Y .S. Department of State
Division of Coastal Resources
One Commerce Plaza, Suite 1010
99 Washington Avenue
Albany, N.Y. 12231

April 6, 2021

RE: Peninsula Babylon LLC
Joseph Johns, President
191 Peninsula Drive
Babylon, NY 11702

Continued:

Policy 17 Non-structural measures to minimize damage to natural resources and property from flooding and erosion shall be used whenever possible. Refacing the bulkhead will allow it to remain functional as an erosion control structure that will protect the upland property. The proposed pier configuration will have no adverse impacts on erosion on this area and will not cause flooding. The project is consistent with this policy.

Policy 21 Water dependent and water enhanced recreation will be encouraged and facilitated, and will be given priority over non-water-related uses along the coast. The proposed pier configuration is within the property owners riparian rights to access to the navigable water seaward of their property. There are no public trails in this area. The pier will have no negative impact on the coastal resources and wildlife habitat. The proposed pier configuration is consistent with this policy.

Policy 22 Development when located adjacent to the shore will provide for water-related recreation whenever such use is compatible with reasonably anticipated demand for such activities, and is compatible with the primary purpose of the development. This property is in a development that was established in the 1960's. Refacing the bulkhead will allow it to remain functional as an erosion control structure that will protect the upland property. The proposed seaward extension of adding a ramp, float and boat lift to the existing pier will allow access to the navigable water for water related recreation for the property owner. The existing pier is not in deep enough water to allow for a float and boat lift to be added to the existing configuration. It was designed using a current water depth survey to reach the navigable water. Most properties in this development already have piers that allow access to the navigable water. The project is consistent with this policy.

Policy 30 Municipal, industrial, and commercial discharge of pollutants, including but not limited to, toxic and hazardous substances, into coastal waters will conform to State and National water quality standards. The proposed refacing of the bulkhead and the proposed pier configuration will only affect the water quality on the installation of the piles that will be pumped into the sandy bottom. The duration of this activity will be about 6 days or less. There will be no toxic or hazardous materials released or discharged into the waterway. The proposed project is consistent with this policy.

Policy 35 Dredging and filling in coastal waters and disposal of dredged material will be undertaken in a manner that meets existing State dredging permit requirements, and protects significant fish and wildlife habitats, scenic resources, natural protective features, important agricultural lands, and wetlands. The proposed dredging in minor and will not adversely affect water quality, fish and wildlife habitats, wetlands, or any other important coastal resources. The purpose of the dredging is to maintain a navigable depth. The proposed project is consistent with this policy.

SHORE SOLUTIONS INC.

DONNA MYERS
32 LINCOLN AVE.
MASSAPEQUA, N.Y. 11758
516-977-3102-FAX
516-816-4163
shoresolutions@aol.com

N. Y .S. Department of State
Division of Coastal Resources
One Commerce Plaza, Suite 1010
99 Washington Avenue
Albany, N.Y. 12231

April 6, 2021

RE: Peninsula Babylon LLC
Joseph Johns, President
191 Peninsula Drive
Babylon, NY 11702

Continued:

Policy 38 The quality and quantity of surface water and groundwater supplies, will be conserved and protected, particularly where such waters constitute the primary or sole source of water supply. The pier configuration will have no impact on the surface or ground water. The proposed refacing of the bulkhead and raising the top of the bulkhead will reduce rainwater runoff into the waterway and is consistent with this policy.

Policy 40 Effluent discharged from major steam electric generating and industrial facilities into coastal waters will not be unduly injurious to fish and wildlife and shall conform to state water quality standards. This project does not pertain to effluent discharge into the waterway. The proposed project is consistent with this policy.

Policy 44 Preserve and protect tidal and freshwater wetlands and preserve the benefits derived from these areas. There are no designated freshwater wetlands at or within 100 feet of this property. The property abuts a tidal wetland littoral zone and the bulkhead separates the upland residential property from the waterway. The waterway is mapped as LZ on the NYSDEC Tidal Wetland Inventory Map Index 2 # 640-504. Refacing the bulkhead will allow it to remain functional as an erosion control structure that will protect the upland property. The proposed bulkhead reconstruction and extending a mooring facility seaward are consistent with this policy.

Sincerely,



Donna Myers

SHORE SOLUTIONS INC.

DONNA MYERS
32 LINCOLN AVE
MASSAPEQUA, N.Y. 11758
516-816-4163
516-977-3102 FAX
shoresolutions@aol.com

To Whom It May Concern:

I hereby authorize Shore Solutions Inc. / Donna Myers to inquire about and apply for the necessary permits for the proposed waterfront construction on my property on my behalf.

Property address: 191 Peninsula Drive

Babylon, NY 11702

Property owners' name: Peninsula Babylon LLC

Authorized Representative: Joseph Johns

Title: President

Mailing address: 2631 Merrick Road

Bellmore, NY 11710

Signature: 

Dated: 3/25/21

VICINITY MAP

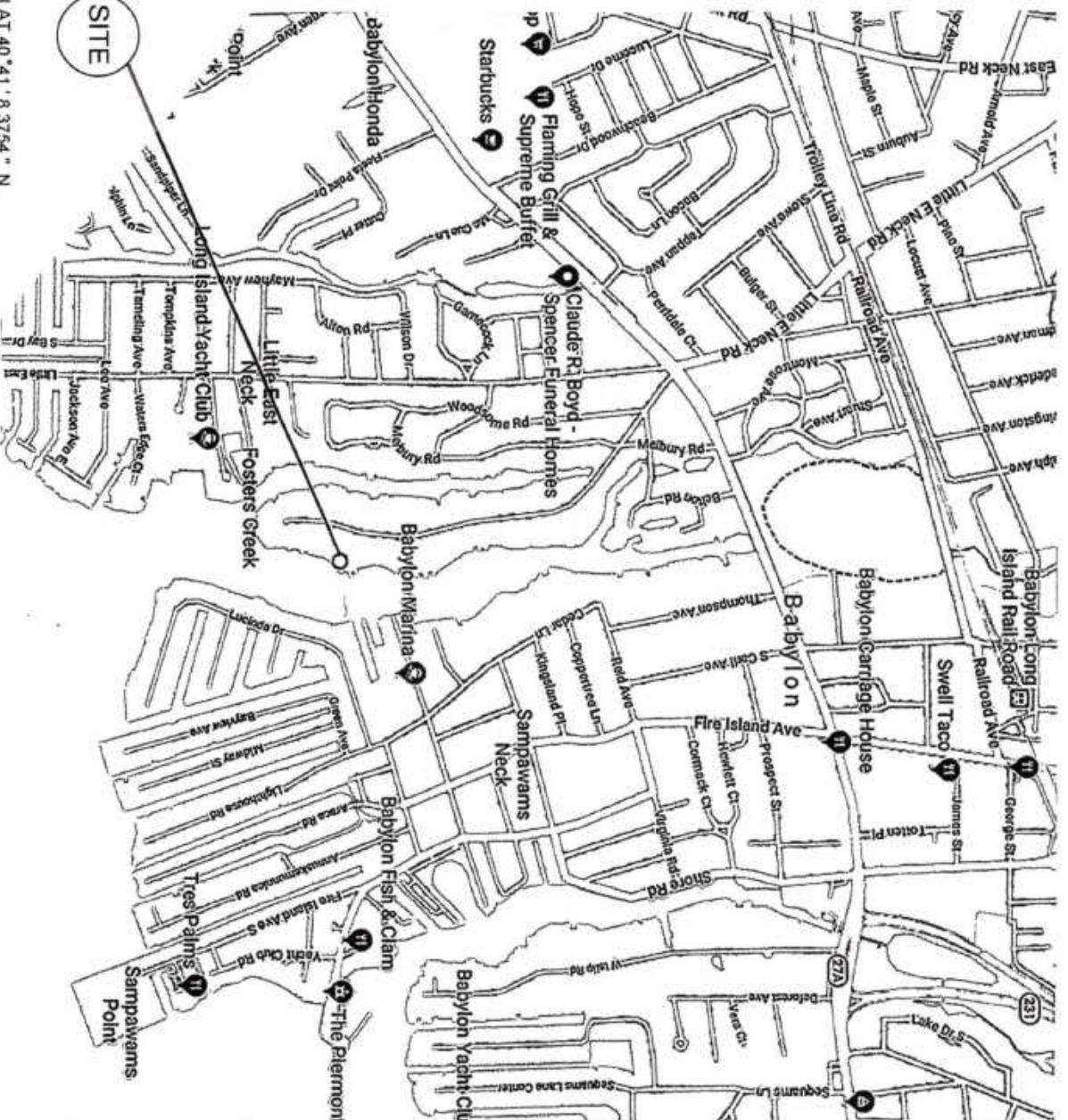

LAT 40°41' 8.3754" N
LONG -73°19' 42.999" W

GOOGLE MAPS



PURPOSE: BULKHEAD REPAIR AND
MAINTENANCE & PROVIDE A SAFE
PRIVATE MOORING FACILITY

SHW= 0.6325'
MHW= 0.4615'
DATUM = 0.0'
MLW= -0.6678'
MLLW= -0.7531'
NOAA VERTICAL DATUM
VERSION 3.4

PREPARED BY
SHORE SOLUTIONS INC - DM
32 LINCOLN AVE
MASSAPEQUA, NY 11758

SCTM#S SD 102 / SEC 17
BLK 2 / LOT 30 & P/O LOT 31
AT: 191 PENINSULA DRIVE
BABYLON, NY 11702
VILLAGE OF BABYLON
SUFFOLK COUNTY
ON: CARL'S RIVER
FOR: PENINSULA BABYLON LLC
JOSEPH JOHNS - PRESIDENT

MARINE STRUCTURES IN VICINITY MAP

SUFFOLK COUNTY GIS
GIS VIEWER 2016



PURPOSE: BULKHEAD REPAIR AND
MAINTENANCE & PROVIDE A SAFE
PRIVATE MOORING FACILITY

SHW= 0.6325'
MHW= 0.4615'
DATUM = 0.0'
MLW= -0.6678'
MLW=-0.7531'
NOAA VERTICAL DATUM
VERSION 3.4

PREPARED BY
SHORE SOLUTIONS INC - DM
32 LINCOLN AVE
MASSAPEQUA, NY 11758

SCTM#S SD 102 / SEC. 17
BLK 2 / LOT 30 & P/O LOT 31
AT: 191 PENINSULA DRIVE
BABYLON, NY 11702
VILLAGE OF BABYLON
SUFFOLK COUNTY
ON: CARL'S RIVER
FOR: PENINSULA BABYLON LLC
JOSEPH JOHNS - PRESIDENT



SITE

200ft

LAT 40°41' 8.3754 " N
LONG -73°19' 42.999 " W

PROJECT PLAN SITE PLAN VIEW

- WATER DEPTHS TAKEN FROM LISA MCQUILKIN LAND SURVEYOR DATED 7/8/2019
- #S REPRESENT DEPTHS BELOW MLLW AS PER NOAA V-DATUM TOOL VERSION 3.4
- ALL DIMENSIONS, SETBACKS AND ELEVATIONS TAKEN FROM SURVEY BY CRAIG M. LEHAT, P.E., PLS DATED 6/6/2020
- INSTALL ELECTRIC CONDUIT AND WATER LINE UNDER DECKING TO BOAT LIFT AS PER STATE AND TOWN CODE
- TRUCK AWAY ALL DEBRIS TO AN APPROVED UPLAND SITE
- VEHICLE ACCESS ROUTE VIA MARINE CONTRACTORS BARGE & PENINSULA DRIVE

ADJACENT PROPERTY OWNER:
PENINSULA BABYLON LLC PROPERTY
189 PENINSULA DRIVE

NO MARINE STRUCTURES
ON ADJACENT PROPERTY
277' TO ADJACENT PIER

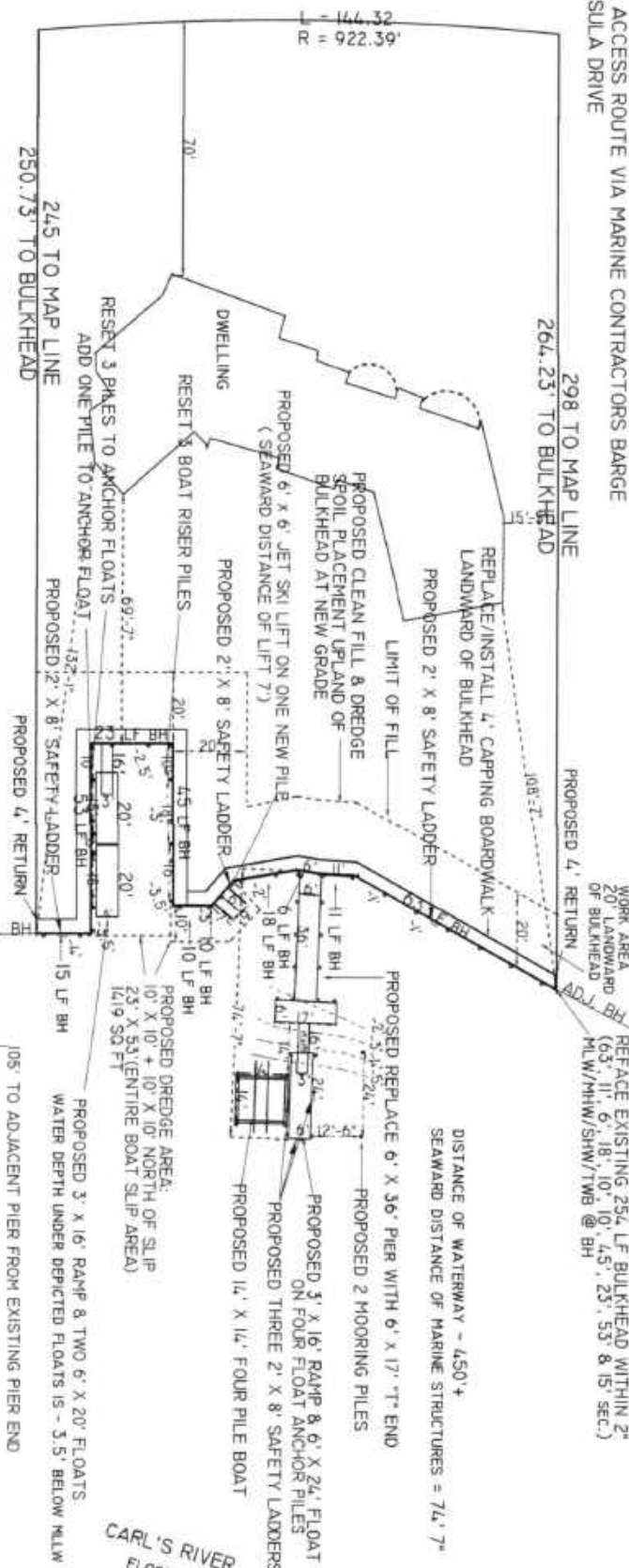

RECOVERY DREDGE: CLAM SHELL BUCKET DREDGE TO A 4' DEPTH BELOW MLLW AND 10' SEAWARD OF BULKHEAD
REMOVING UP TO 25 CY SANDY MATERIAL / TRUCK IN UP TO 125 CY CLEAN FILL / PLACE FILL & DREDGE SPOIL UPLAND OF BULKHEAD TOTAL FILL UP TO 150 CY

ADJACENT PROPERTY OWNER:
JOSEPH J. TYMINSKI RESIDENCE
195 PENINSULA DRIVE

- TIDAL LINES DOCUMENTED & TIDAL WETLAND
BOUNDARY DELINEATED @ MHW - 120 PM
8/28/2020 BY DONNA MYERS / SHORE SOLUTIONS INC.

PURPOSE: BULKHEAD REPAIR AND MAINTENANCE / MINOR DREDGING / REPLACE FIXED T* PIER, ADD FLOATS & LIFT TO ACCESS NAVIGABLE WATER FOR A SAFE PRIVATE MOORING FACILITY
PROPOSED: REFACE 254 SMOOTH BULKHEAD BOARD ON BOARD WITHIN 2' ADD PILES ALONG BULKHEAD FACE 10' OC / RAISE BULKHEAD 18" UP TO 3.9 ELE. / INSTALL (2) 4' RETURNS
INSTALL 3 LADDERS OFF BULKHEAD / INSTALL 4' CAPPING BOARDWALK / INSTALL JET SKI LIFT ON ONE PILE OFF THE BULKHEAD NORTH OF THE BOAT SLIP / INSTALL 3' X 16' RAMP & TWO 6' X 20' FLOATS ON 4 PILES (3 EXISTING & ONE NEW) IN BOAT SLIP / REPLACE 6' X 36' OPEN PILE FIXED PIER WITH 6' X 17' T* / ADD 3' X 16' RAMP OFF PIER END & ONE 6' X 24' FLOAT WITH FOUR ANCHOR PILES / INSTALL 4 PILE BOAT LIFT ON THE SOUTH SIDE OF THE 24' FLOAT / INSTALL TWO MOORING PILES NORTH OF FLOAT / INSTALL 3 LADDERS ON THE FLOAT / RECOVERY DREDGE 10' SEAWARD OF 20' SECTION OF BULKHEAD NORTH OF BOAT SLIP / DREDGE ENTIRE 23' X 53' BOAT SLIP / TRUCK IN CLEAN FILL

SCTM# SD 102 / SEC 17 /
BLK 2 / LOT 30 & P/O LOT 31
AT: 191 PENINSULA DRIVE
BABYLON, NY 11702
VILLAGE OF BABYLON
SUFFOLK COUNTY
ON: CARL'S RIVER
FOR: PENINSULA BABYLON LLC
JOSEPH JOHNS - PRESIDENT

SHW= 0.6325'
MHW= 0.4615'
DATUM = 0.0'
MLW= -0.6678'
MLLW= -0.7531'

LAT 40° 41' 7.1478" N
LONG -73° 19' 43.6866" W

SCALE 1" = 50'

PREPARED 3/29/2021 BY
SHORE SOLUTIONS INC.

PAGE 3 OF 6

CROSSVIEW #1 PIER PROFILE

PROPOSED FLOAT CONSTRUCTION:
2" X 10" CCA TOP & BOTTOM FRAME
4" X 4" CCA POSTS
FLOATATION BILLETS OR
PERMA FLOATATION DRUMS
2" X 6" ACQ DECKING

SEAWARD DISTANCE OF PROPOSED
MARINE STRUCTURES 74.7"
450'
DISTANCE OF WATERWAY ~ 500'
TO A BULKHEADED SHORELINE

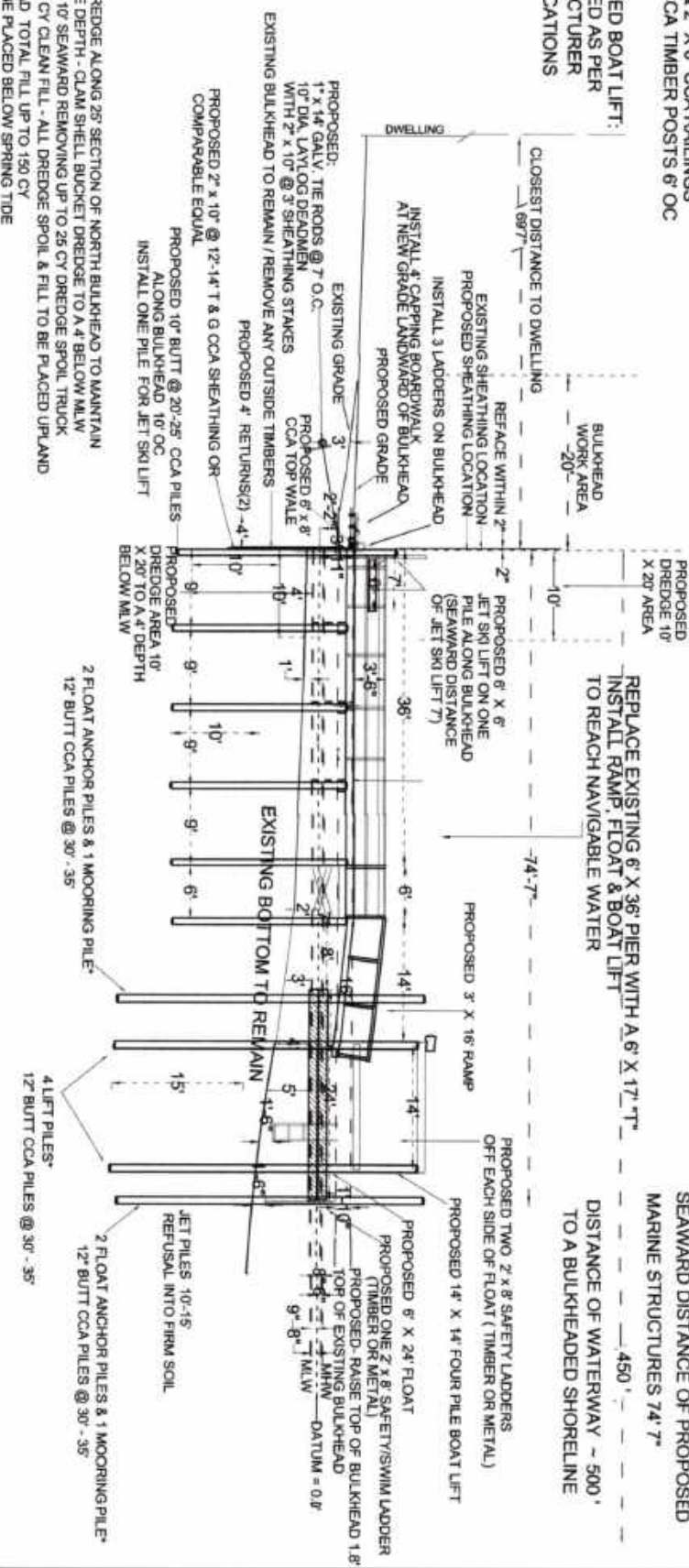

2 FLOAT ANCHOR PILES & 1 MOORING PILE*
12" BUTT CCA PILES @ 30' - 35'

PROPOSED: RAFFER 254 SMO. 4 BULKHEAD BOARD ON BOARD WITHIN 2" ADD PILES ALONG BULKHEAD FACE 10' OC / RAISE BULKHEAD 1.8' UP TO 3.9 ELE. / INSTALL (2) 4" RETURNS
INSTALL 3 LADDERS OFF BULKHEAD / INSTALL 4" CAPPING BOARDWALK / INSTALL JET SKI LIFT ON ONE PILE OFF THE BULKHEAD NORTH OF THE BOAT SLIP / INSTALL 3' X 16" RAMP
& TWO 6' X 20' FLOATS ON 4 PILES (3 EXISTING & ONE NEW) IN BOAT SLIP / REPLACE 6' X 36" OPEN PILE FIXED PIER WITH 6' X 17' "T" / ADD 3' X 16" RAMP OFF PIER END & ONE
6' X 24" FLOAT WITH FOUR ANCHOR PILES / INSTALL 4 PILE BOAT LIFT ON THE SOUTH SIDE OF THE 24' FLOAT / INSTALL TWO MOORING PILES NORTH OF FLOAT / INSTALL 3
LADDERS ON THE FLOAT / RECOVERY DREDGE 10' SEAWARD OF BULKHEAD NORTH OF BOAT SLIP / DREDGE ENTIRE 23' X 53' BOAT SLIP / TRUCK IN CLEAN FILL

AT: 191 PENINSULA DRIVE
BABYLON, NY 11702
VILLAGE OF BABYLON / SUFFOLK COUNTY
ON: CARL'S RIVER
FOR: PENINSULA BABYLON LLC
JOSEPH JOHNS - PRESIDENT

PROJECT PLAN CROSSVIEW #2

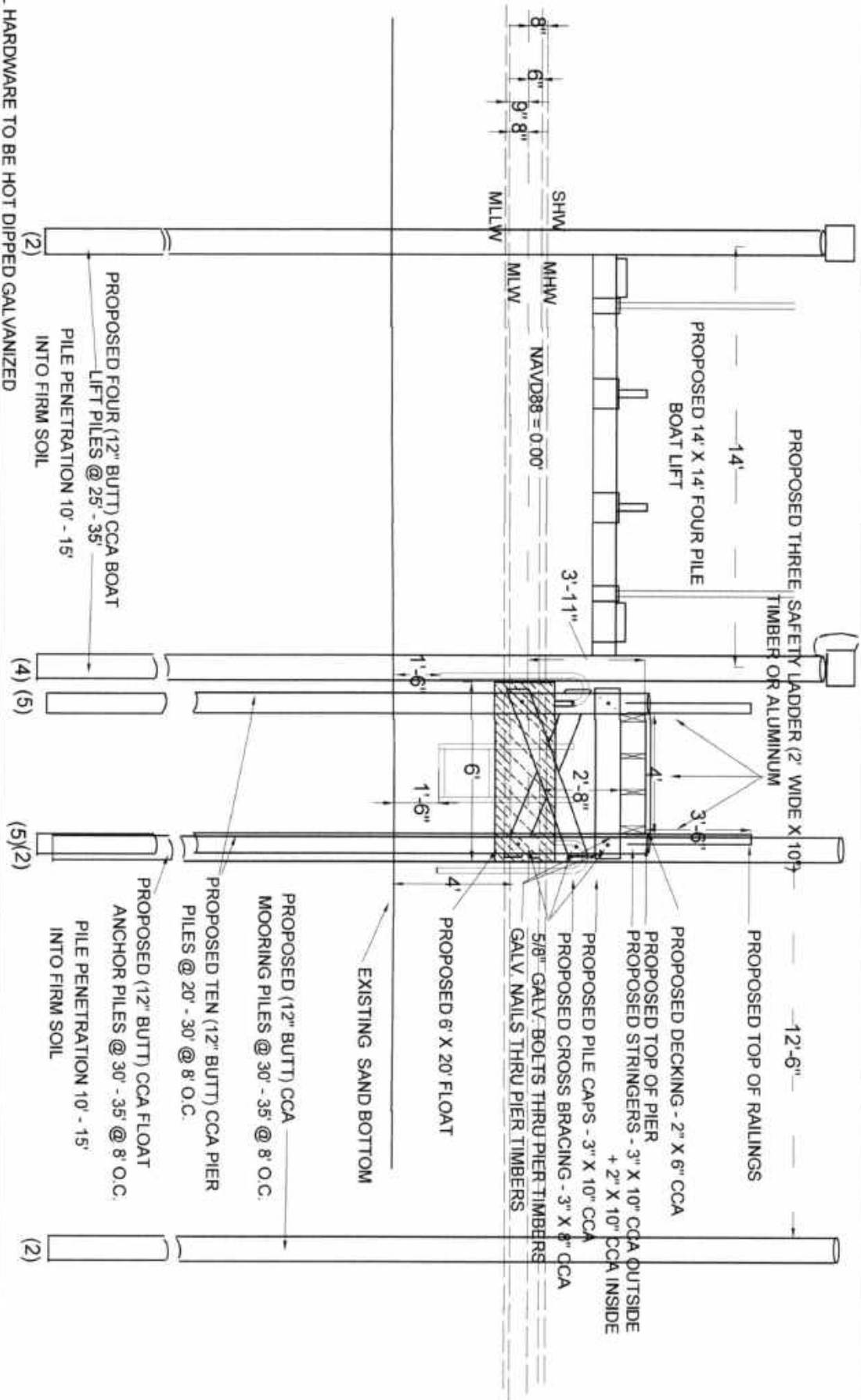

ALL HARDWARE TO BE HOT DIPPED GALVANIZED

PURPOSE: BULKHEAD REPAIR AND MAINTENANCE / MINOR DREDGING / REPLACE FIXED T^h PIER, ADD FLOATS & LIFT TO ACCESS NAVIGABLE WATER FOR A SAFE PRIVATE MOORING FACILITY
 REPLACE 6' X 36' OPEN PILE FIXED PIER WITH 6' X 17' T^h / ADD 3' X 16' RAMP OFF PIER END & ONE 6' X 24' FLOAT TO REACH NAVIGABLE WATER SECURE WITH 4 PILES /
 INSTALL 3 LADDERS ON FLOAT / INSTALL 4 PILE BOAT LIFT ON THE SOUTH SIDE OF THE FLOAT & INSTALL TWO MOORING PILES ON THE NORTH SIDE OF FLOAT

SHW= 0.6325' MHW= 0.4615' DATUM = 0.0' MLW= -0.6678' MLLW= -0.7531' NOAA VERTICAL DATUM	SCTM# SD 102 / SEC 17 / BLK 2 / LOT 30 & P/O LOT 31	SCALE 1" = 5'	PREPARED 3/29/2020 BY SHORE SOLUTIONS INC.	AT: 191 PENINSULA DRIVE BABYLON, NY 11702 VILLAGE OF BABYLON SUFFOLK COUNTY FOR: PENINSULA BABYLON LLC JOSEPH JOHNS - PRESIDENT ON: CARL'S RIVER
VERSION 3.4	LAT 40° 41' 7.1052" N LONG -73° 19' 43.6728" W	PAGE 5 OF 6		

PROJECT PLAN CROSSVIEW #3 BOAT SLIP AREA

boardwalk construction:

- 2" x 6" ACQ decking
- 2" x 6" CCA stringers @ 16" O.C.
- 5/4" x 6" composite decking
- 2" x 6" CCA stringers @ 12" O.C.

proposed sheathing location

existing sheathing location

RECOVERY DREDGE : CLAM SHELL BUCKET DREDGE TO A 4' DEPTH BELOW MLW AND 10' SEAWARD OF BULKHEAD REMOVING UP TO 25 CY SANDY MATERIAL - DREDGE ENTIRE 23' X 53' BOAT SLIP - PLACE DREDGE SPOIL UPLAND OF BULKHEAD - BACKFILL TO A LEVEL GRADE TRUCK IN 125 CY CLEAN FILL - TOTAL FILL UP TO 150 CY

WORK AREA
20' landward

DREDGE AREA

23' WIDE X 53' BOAT SLIP

23' x 53' = 1219 sq ft
10' x 20' = 200 sq ft
total = 1419 sq ft

DISTANCE OF WATERWAY ~ 500'
TO A BULKHEADED SHORELINE

CLOSEST DISTANCE TO DWELLING

dwelling

replace/install 4' capping boardwalk at new grade landward of bulkhead

proposed grade

proposed:

1" x 14" galv. tie rods @ 7' O.C.
10" dia. lagging deadmen
with 2" x 10" @ 3' sheathing stakes

existing grade

existing bulkhead to remain

proposed 10" butt @ 25'-30' CCA piles
along bulkhead 10' O.C.

leave 3 piles high as boat risers

proposed 5/8" galv. top bolt- 5/8" galv. nut & 2" galv. washer

proposed 2" x 8" CCA outside rail

remove any outside timbers

camp

float

float

float

float

float

float

float

float

float

float

float

float

float

float

float

float

float

float

float

float

MLW
SHW
DATUM = 0.0'

TRUCK AWAY ALL RIP OUT
TO AN APPROVED UPLAND SITE

PURPOSE: BULKHEAD REPAIR AND MAINTENANCE / MINOR DREDGING / REPLACE FIXED T" PIER, ADD FLOATS & LIFT TO ACCESS NAVIGABLE WATER FOR A SAFE PRIVATE MOORING FACILITY

PROPOSED: REFACE 254 SMOOTH BULKHEAD BOARD WITHIN 2' ADD PILES ALONG BULKHEAD FACE 10' OC / RAISE BULKHEAD 1.8' UP TO 3.9' ELE / INSTALL (2) 4' RETURNS
INSTALL 3 LADDERS OFF BULKHEAD / INSTALL 4' CAPPING BOARDWALK / INSTALL JET SKI LIFT ON ONE PILE OFF THE BULKHEAD NORTH OF THE BOAT SLIP / INSTALL 3' X 16' RAMP
& TWO 6' X 20' FLOATS ON 4 PILES (3 EXISTING & ONE NEW) IN BOAT SLIP / REPLACE 6' X 36' OPEN PILE FIXED PIER WITH 6' X 17' T" / ADD 3' X 16' RAMP OFF PIER END & ONE 6' X 24'
FLOAT WITH FOUR ANCHOR PILES / INSTALL 4 PILE BOAT LIFT ON THE SOUTH SIDE OF THE 24' FLOAT / INSTALL TWO MOORING PILES NORTH OF FLOAT / INSTALL 3 LADDERS ON
THE FLOAT / RECOVERY DREDGE 10' SEAWARD OF 20' SECTION OF BULKHEAD NORTH OF BOAT SLIP / DREDGE ENTIRE 23' X 53' BOAT SLIP / TRUCK IN CLEAN FILL

SHW= 0.6325'
MHW= 0.4615'
DATUM = 0.0'
MLW= -0.6678'
MLW= -0.7531'
NOAA VERTICAL DATUM

SCTM# SD 102 / SEC 17 /
BLK 2 / LOT 30 & P/O 31

SCALE 1" = 10'

PREPARED 3/29/2021 BY
SHORE SOLUTIONS INC.

PAGE 6 OF 6

AT: 191 PENINSULA DRIVE
BABYLON, NY 11702
VILLAGE OF BABYLON / SUFFOLK COUNTY
ON: CARL'S RIVER
FOR: PENINSULA BABYLON LLC
JOSEPH JOHNS - PRESIDENT

NEW YORK STATE DEPARTMENT OF STATE
COASTAL MANAGEMENT PROGRAM

Federal Consistency Assessment Form

An applicant, seeking a permit, license, waiver, certification or similar type of approval from a federal agency which is subject to the New York State Coastal Management Program (CMP), shall complete this assessment form for any proposed activity that will occur within and/or directly affect the State's Coastal Area. This form is intended to assist an applicant in certifying that the proposed activity is consistent with New York State's CMP as required by U.S. Department of Commerce regulations (15 CFR 930.57). It should be completed at the time when the federal application is prepared. The Department of State will use the completed form and accompanying information in its review of the applicant's certification of consistency.

A. **APPLICANT** (please print)

1. Name: Peninsula Babylon LLC, Joseph Johns - President
2. Address: 2631 Merrick Road, Suite 406 Bellmore, NY 11710
3. Telephone: Area Code () 516-456-6001

B. **PROPOSED ACTIVITY:**

1. Brief description of activity:

Reface 254 LF timber flush face bulkhead Raise top of bulkhead 1.8'. Install
two 4' returns. Replace bdwk & open pile pier. Add ramp, floats, boat lifts
mooring piles. Dredge 10' x 20' & boat slip = 1419 sq. ft. Truck in clean fill.

2. Purpose of activity:

Bulkhead repair and maintenance & provide a safe private mooring.

3. Location of activity:

<u>Suffolk</u>	<u>Babylon, NY 11702</u>	<u>191 Peninsula Drive</u>
County	City, Town , or Village	Street or Site Description

4. Type of federal permit/license required: USACE

5. Federal application number, if known: _____

6. If a state permit/license was issued or is required for the proposed activity, identify the state agency and provide the application or permit number, if known:

NYSDEC NYSDOS

C. **COASTAL ASSESSMENT** Check either "YES" or "NO" for each of these questions. The numbers following each question refer to the policies described in the CMP document (see footnote on page 2) which may be affected by the proposed activity.

1. Will the proposed activity result in any of the following: YES/NO

- | | | |
|--|-------------------------------------|-------------------------------------|
| a. Large physical change to a site within the coastal area which will require the preparation of an environmental impact statement? (11, 22, 25, 32, 37, 38, 41, 43) | <input type="checkbox"/> | <input checked="" type="checkbox"/> |
| b. Physical alteration of more than two acres of land along the shoreline, land under water or coastal waters? (2, 11, 12, 20, 28, 35, 44) | <input type="checkbox"/> | <input checked="" type="checkbox"/> |
| c. Revitalization/redevelopment of a deteriorated or underutilized waterfront site? (1) | <input type="checkbox"/> | <input checked="" type="checkbox"/> |
| d. Reduction of existing or potential public access to or along coastal waters? (19, 20) | <input type="checkbox"/> | <input checked="" type="checkbox"/> |
| e. Adverse effect upon the commercial or recreational use of coastal fish resources? (9,10) | <input type="checkbox"/> | <input checked="" type="checkbox"/> |
| f. Siting of a facility essential to the exploration, development and production of energy resources in coastal waters or on the Outer Continental Shelf? (29) | <input type="checkbox"/> | <input checked="" type="checkbox"/> |
| g. Siting of a facility essential to the generation or transmission of energy? (27) | <input type="checkbox"/> | <input checked="" type="checkbox"/> |
| h. Mining, excavation, or dredging activities, or the placement of dredged or fill material in coastal waters? (15, 35) | <input checked="" type="checkbox"/> | <input type="checkbox"/> |
| i. Discharge of toxics, hazardous substances or other pollutants into coastal waters? (8, 15, 35) | <input type="checkbox"/> | <input checked="" type="checkbox"/> |
| j. Draining of stormwater runoff or sewer overflows into coastal waters? (33) | <input type="checkbox"/> | <input checked="" type="checkbox"/> |
| k. Transport, storage, treatment, or disposal of solid wastes or hazardous materials? (36, 39) | <input type="checkbox"/> | <input checked="" type="checkbox"/> |
| l. Adverse effect upon land or water uses within the State's small harbors? (4) | <input type="checkbox"/> | <input checked="" type="checkbox"/> |

2. Will the proposed activity affect or be located in, on, or adjacent to any of the following: YES/NO

- | | | |
|---|-------------------------------------|-------------------------------------|
| a. State designated freshwater or tidal wetland? (44) | <input checked="" type="checkbox"/> | <input type="checkbox"/> |
| b. Federally designated flood and/or state designated erosion hazard area? (11, 12, 17) | <input checked="" type="checkbox"/> | <input type="checkbox"/> |
| c. State designated significant fish and/or wildlife habitat? (7) | <input type="checkbox"/> | <input checked="" type="checkbox"/> |
| d. State designated significant scenic resource or area? (24) | <input type="checkbox"/> | <input checked="" type="checkbox"/> |
| e. State designated important agricultural lands? (26) | <input type="checkbox"/> | <input checked="" type="checkbox"/> |
| f. Beach, dune or Barrier Island? (12) | <input type="checkbox"/> | <input checked="" type="checkbox"/> |
| g. Major ports of Albany, Buffalo, Ogdensburg, Oswego or New York? (3) | <input type="checkbox"/> | <input checked="" type="checkbox"/> |
| h. State, county, or local park? (19, 20) | <input type="checkbox"/> | <input checked="" type="checkbox"/> |
| i. Historic resource listed on the National or State Register of Historic Places? (23) | <input type="checkbox"/> | <input checked="" type="checkbox"/> |

3. Will the proposed activity require any of the following: YES/NO

- | | | |
|--|-------------------------------------|-------------------------------------|
| a. Waterfront site? (2, 21, 22) | <input checked="" type="checkbox"/> | <input type="checkbox"/> |
| b. Provision of new public services or infrastructure in undeveloped or sparsely populated sections of the coastal area? (5) | <input type="checkbox"/> | <input checked="" type="checkbox"/> |
| c. Construction or reconstruction of a flood or erosion control structure? (13, 14, 16) | <input checked="" type="checkbox"/> | <input type="checkbox"/> |
| d. State water quality permit or certification? (30, 38, 40) | <input checked="" type="checkbox"/> | <input type="checkbox"/> |
| e. State air quality permit or certification? (41, 43) | <input type="checkbox"/> | <input checked="" type="checkbox"/> |

4. Will the proposed activity occur within and/or affect an area covered by a State-approved local waterfront revitalization program, or State-approved regional coastal management program? (see policies in program document*) ☐ ☒

D. ADDITIONAL STEPS

1. If all of the questions in Section C are answered "NO", then the applicant or agency shall complete Section E and submit the documentation required by Section F.
2. If any of the questions in Section C are answered "YES", then the applicant or agent is advised to consult the CMP, or where appropriate, the local waterfront revitalization program document*. The proposed activity must be analyzed in more detail with respect to the applicable state or local coastal policies. On a separate page(s), the applicant or agent shall: (a) identify, by their policy numbers, which coastal policies are affected by the activity, (b) briefly assess the effects of the activity upon the policy; and, (c) state how the activity is consistent with each policy. Following the completion of this written assessment, the applicant or agency shall complete Section E and submit the documentation required by Section F.

E. CERTIFICATION

The applicant or agent must certify that the proposed activity is consistent with the State's CMP or the approved local waterfront revitalization program, as appropriate. If this certification cannot be made, the proposed activity shall not be undertaken. If this certification can be made, complete this Section.

"The proposed activity complies with New York State's approved Coastal Management Program, or with the applicable approved local waterfront revitalization program, and will be conducted in a manner consistent with such program."

Applicant/Agent's Name: Shore Solutions Inc. / Donna Myers
Address: 32 Lincoln Avenue Massapequa, NY 11758
Telephone: Area Code () 516-816-4163
Applicant/Agent's Signature:  Date: 3-30-21

F. SUBMISSION REQUIREMENTS

1. The applicant or agent shall submit the following documents to the **New York State Department of State, Office of Planning and Development, Attn: Consistency Review Unit, One Commerce Plaza-Suite 1010, 99 Washington Avenue, Albany, New York 12231.**
 - a. Copy of original signed form.
 - b. Copy of the completed federal agency application.
 - c. Other available information which would support the certification of consistency.
2. The applicant or agent shall also submit a copy of this completed form along with his/her application to the federal agency.
3. If there are any questions regarding the submission of this form, contact the Department of State at (518) 474-6000.

*These state and local documents are available for inspection at the offices of many federal agencies, Department of environmental Conservation and Department of State regional offices, and the appropriate regional and county planning agencies. Local program documents are also available for inspection at the offices of the appropriate local government.



JOINT APPLICATION FORM

For Permits for activities affecting streams, waterways, waterbodies, wetlands, coastal areas, sources of water, and endangered and threatened species.

You must separately apply for and obtain Permits from each involved agency before starting work. Please read all instructions.

1. Applications To:

>NYS Department of Environmental Conservation



Check here to confirm you sent this form to NYSDEC.

Check all permits that apply:

☐ Stream Disturbance

☒ Excavation and Fill in
Navigable Waters

☒ Docks, Moorings or
Platforms

☐ Dams and Impound-
ment Structures

☒ 401 Water Quality
Certification

☐ Freshwater Wetlands

☒ Tidal Wetlands

☐ Wild, Scenic and
Recreational Rivers

☒ Coastal Erosion
Management

☐ Water Withdrawal

☐ Long Island Well

☐ Incidental Take of
Endangered /
Threatened Species

>US Army Corps of Engineers



Check here to confirm you sent this form to USACE.

Check all permits that apply:

☐ Section 404 Clean Water Act

☐ Section 10 Rivers and Harbors Act

Is the project Federally funded? ☐ Yes ☒ No

If yes, name of Federal Agency:

General Permit Type(s), if known: NW #2, # 3 & # 19

Preconstruction Notification: ☐ Yes ☐ No

>NYS Office of General Services



Check here to confirm you sent this form to NYSOGS.

Check all permits that apply:

☐ State Owned Lands Under Water

☐ Utility Easement (pipelines, conduits, cables, etc.)

☐ Docks, Moorings or Platforms

>NYS Department of State



Check here to confirm you sent this form to NYSDOS.

Check if this applies: ☒ Coastal Consistency Concurrence

2. Name of Applicant

Peninsula Babylon LLC, Joseph Johns - President

Taxpayer ID (if applicant is NOT an individual)

EIN-82-2559435

Mailing Address

2631 Merrick Road, Suite 406

Post Office / City

Bellmore

State

NY

Zip

11710

Telephone 516-456-6001

Email josephwjohs@gmail.com

Applicant Must be (check all that apply): ☒ Owner ☐ Operator ☐ Lessee

3. Name of Property Owner (if different than Applicant)

Mailing Address

Post Office / City

State

Zip

Telephone

Email

For Agency Use Only

Agency Application Number:

4. Name of Contact / Agent

Donna Myers / Shore Solutions Inc.

Mailing Address

32 Lincoln Ave

Post Office / City

Massapequa

State Zip

NY

11758

Telephone 516-816-4163

Email shoresolutions@aol.com

5. Project / Facility Name

Residence

Property Tax Map Section / Block / Lot Number:

sec. 17 / blk 2 / lot 30 & P/O 31

Project Street Address, if applicable

191 Peninsula Drive

Post Office / City

Babylon

State Zip

NY

11702

Provide directions and distances to roads, intersections, bridges and bodies of water

At Merrick Road & Peninsula Drive go S on Peninsula Dr 0.7miles to #191.

Located on Carl's River

☒ Town ☐ Village ☐ City

County

Stream/Waterbody Name

Babylon

Suffolk

Carl's River

Project Location Coordinates: Enter Latitude and Longitude in degrees, minutes, seconds:

Latitude: 40 ° 41 ' 7.1052 " Longitude: -73 ° 19 ' 43.6728 "

6. Project Description: Provide the following information about your project. Continue each response and provide any additional information on other pages. **Attach plans on separate pages.****a. Purpose of the proposed project:**

Reface 254 LF timber flush face bulkhead (63', 11', 6', 18', 10', 10', 45', 23', 53' & 15' sec) board on board within 2". Raise top of bulkhead up to 1.8'. Install two 4' returns. Install 3' x 16' ramp, two 6' x 20' floats on 3 ex. piles, add 1 pile/Replace 6' x 36' pier with a 6' x 17' "T", install 3' x 16' ramp, 6' x 24' float, 14' x 14' four pile boat lift, 2 mooring piles & 6' x 6' lift. Recovery dredge. Truck in clean fill. Replace 4' bdwk.

b. Description of current site conditions:

Residence that has a bulkhead that needs to be repaired and needs a safe mooring facility.

c. Proposed site changes:

reface 254 LF bulkhead (63', 11', 6', 18', 10', 10', 45', 23', 53' & 15' sec) board on board within 2" add 10" piles 10' OC along BH, add two 4' returns. Raise top of bulkhead up to 1.8'. Install 3' x 16' ramp, two 6' x 20' floats on 3 ex. piles add 1 pile in boat slip/Replace 6' x 36' pier with a 6' x 17' "T", install 3' x 16' ramp, 6' x 24' float, 14' x 14' four pile boat lift, 2 mooring piles & a 6' x 6' lift. Dredge. Truck in clean fill.

d. Type of structures and fill materials to be installed, and quantity of materials to be used (e.g., square feet of coverage, cubic yards of fill material, structures below ordinary/mean high water, etc.):

2" x 10" x 14" CCA or solid core sheathing or comparable equal in place, add piles 10' OC along BH, 6" x 8" CCA top wale, 1" x 14' tie rods. Install 3' x 16' ramp, two 6' x 20' floats on 3 ex. piles in boat slip add 1 pile/Replace 6' x 36' pier with a 6' x 17' "T", install 3' x 16' ramp, 6' x 24' float, 14' x 14' four pile boat lift, 2 mooring piles & a 6' x 6' jet ski lift. Dredge up to 25 cy. place fill upland of bulkhead. Truck in clean fill.

e. Area of excavation or dredging, volume of material to be removed, location of dredged material placement:

Dredge up to 25 CY 10' seaward of bulkhead place dredge spoil upland of new bulkhead. Dredge area 10' x 20' = 200 sq. ft. Dredge area 23' x 53' = 1219 sq. ft. Total 1419 sq. ft.

f. Is tree cutting or clearing proposed? ☐ Yes If Yes, explain below. ☒ No

Timing of the proposed cutting or clearing (month/year):

Number of trees to be cut:

Acreage of trees to be cleared:

g. Work methods and type of equipment to be used:

Repair bulkhead using crane on marine contractors barge. A Bob cat excavator will be used to truck in fill and clam shell bucket dredge 10' seaward of bulkhead.

h. Describe the planned sequence of activities:

Excavate existing fill upland of bulkhead, install sheathing board on board within 2", add top wale. Excavate a trench 15 ft landward of bulkhead install laylog deadmen with sheathing stakes to keep in position. drill hole through wale & sheathing in BH and in laylog. install tierods. Dredge. Truck in fill. Install pier, floats, boat lift, ramp, anchor piles, jet ski lift off bulkhead and mooring piles.

i. Pollution control methods and other actions proposed to mitigate environmental impacts:

There should be no pollution from this job. There will be minimal environmental impacts, this job will take a week or two to complete.

j. Erosion and silt control methods that will be used to prevent water quality impacts:

There should be no impacts to water quality. There will be minimal environmental impacts, this job will take a week or two to complete.

k. Alternatives considered to avoid regulated areas. If no feasible alternatives exist, explain how the project will minimize impacts:

The best way to reinforce the bulkhead is by repairing it with new sheathing. Repairing the bulkhead will ensure years of function and cause the least amount of impact to the area. Bulkhead replacement would cause more environmental impact. The contractor is an experienced dock builder and he will repair the bulkhead with minimal disturbance to the environment.

l. Proposed use: ☒ Private ☐ Public ☐ Commercial

m. Proposed Start Date: Estimated Completion Date:

n. Has work begun on project? ☐ Yes If Yes, explain below. ☒ No

o. Will project occupy Federal, State, or Municipal Land? ☐ Yes If Yes, explain below. ☒ No

p. List any previous DEC, USACE, OGS or DOS Permit / Application numbers for activities at this location:

1-4720-01581/00001 Bulkhead / 1-4720-01581/00006 subdivide property /1-4720-01581/00007 NJ Letter

q. Will this project require additional Federal, State, or Local authorizations, including zoning changes?

☒ Yes If Yes, list below. ☐ No

Army Corps of Engineers
NYSDOS
NYSDEC

7. Signatures.

Applicant and Owner (If different) must sign the application.

Append additional pages of this Signature section if there are multiple Applicants, Owners or Contact/Agents.

I hereby affirm that information provided on this form and all attachments submitted herewith is true to the best of my knowledge and belief.

Permission to Inspect - I hereby consent to Agency inspection of the project site and adjacent property areas. Agency staff may enter the property without notice between 7:00 am and 7:00 pm, Monday - Friday. Inspection may occur without the owner, applicant or agent present. If the property is posted with "keep out" signs or fenced with an unlocked gate, Agency staff may still enter the property. Agency staff may take measurements, analyze site physical characteristics, take soil and vegetation samples, sketch and photograph the site. I understand that failure to give this consent may result in denial of the permit(s) sought by this application.

False statements made herein are punishable as a Class A misdemeanor pursuant to Section 210.45 of the NYS Penal Law. Further, the applicant accepts full responsibility for all damage, direct or indirect, of whatever nature, and by whomever suffered, arising out of the project described herein and agrees to indemnify and save harmless the State from suits, actions, damages and costs of every name and description resulting from said project. In addition, Federal Law, 18 U.S.C., Section 1001 provides for a fine of not more than \$10,000 or imprisonment for not more than 5 years, or both where an applicant knowingly and willingly falsifies, conceals, or covers up a material fact; or knowingly makes or uses a false, fictitious or fraudulent statement.

Signature of Applicant

Date

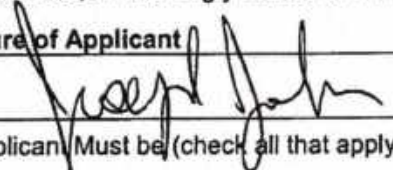

3/17/21

Applicant Must be (check all that apply): ☒ Owner ☐ Operator ☐ Lessee

Printed Name

Title

Peninsula Babylon LLC, Joseph Johns

President

Signature of Owner (if different than Applicant)

Date

Printed Name

Title

Signature of Contact / Agent

Date

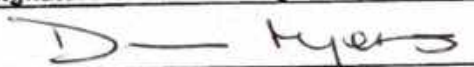

3-25-2021

Printed Name

Title

Donna Myers

President, Shore Solutions Inc.

For Agency Use Only

DETERMINATION OF NO PERMIT REQUIRED

Agency Application Number

(Agency Name) has determined that No Permit is required from this Agency for the project described in this application.

Agency Representative:

Printed Name

Title

Signature

Date

Short Environmental Assessment Form

Part 1 - Project Information

Instructions for Completing

Part 1 - Project Information. The applicant or project sponsor is responsible for the completion of Part 1. Responses become part of the application for approval or funding, are subject to public review, and may be subject to further verification. Complete Part 1 based on information currently available. If additional research or investigation would be needed to fully respond to any item, please answer as thoroughly as possible based on current information.

Complete all items in Part 1. You may also provide any additional information which you believe will be needed by or useful to the lead agency; attach additional pages as necessary to supplement any item.

Part 1 - Project and Sponsor Information							
Peninsula Babylon LLC, Joseph Johns - President							
Name of Action or Project: Bulkhead repair and maintenance. Recovery dredge. Truck in clean fill. Provide a safe private mooring.							
Project Location (describe, and attach a location map): 191 Peninsula Drive Babylon, NY 11702 Located on Carl's River.							
Brief Description of Proposed Action: Reface 254 LF timber flush face bulkhead (63', 11', 6', 18', 10', 10', 45', 23', 53' & 15' sec) board on board within 2". Raise top of bulkhead up to 1.8'. Install two 4' returns. Install 3' x 16' ramp, two 6' x 20' floats on 3 ex. piles, add 1 pile in boat slip /Replace 6' x 36' pier with a 6' x 17' "T", install 3' x 16' ramp, 6' x 24' float, 14' x 14' four pile boat lift, 2 mooring piles & 6' x 6' jet ski lift off the bulkhead north of the boat slip. Recovery dredge boat slip and 10 x 20' area off bulkhead north of boat slip. Truck in clean fill. Replace 4' boardwalk.							
Name of Applicant or Sponsor: Shore Solutions Inc. Donna Myers - President		Telephone: 516-816-4163 E-Mail: shoresolutions@AOL.com					
Address: 32 Lincoln Avenue							
City/PO: Massapequa		State: NY	Zip Code: 11758				
1. Does the proposed action only involve the legislative adoption of a plan, local law, ordinance, administrative rule, or regulation? If Yes, attach a narrative description of the intent of the proposed action and the environmental resources that may be affected in the municipality and proceed to Part 2. If no, continue to question 2.			<table border="1" style="width: 100%; border-collapse: collapse;"> <tr> <td style="width: 50%; padding: 5px;">NO</td> <td style="width: 50%; padding: 5px;">YES</td> </tr> <tr> <td style="text-align: center; padding: 5px;"><input checked="" type="checkbox"/></td> <td style="text-align: center; padding: 5px;"><input type="checkbox"/></td> </tr> </table>	NO	YES	<input checked="" type="checkbox"/>	<input type="checkbox"/>
NO	YES						
<input checked="" type="checkbox"/>	<input type="checkbox"/>						
2. Does the proposed action require a permit, approval or funding from any other governmental Agency? If Yes, list agency(s) name and permit or approval: NYSDEC USACE NYSDOS			<table border="1" style="width: 100%; border-collapse: collapse;"> <tr> <td style="width: 50%; padding: 5px;">NO</td> <td style="width: 50%; padding: 5px;">YES</td> </tr> <tr> <td style="text-align: center; padding: 5px;"><input type="checkbox"/></td> <td style="text-align: center; padding: 5px;"><input checked="" type="checkbox"/></td> </tr> </table>	NO	YES	<input type="checkbox"/>	<input checked="" type="checkbox"/>
NO	YES						
<input type="checkbox"/>	<input checked="" type="checkbox"/>						
3.a. Total acreage of the site of the proposed action? .832 acres b. Total acreage to be physically disturbed? 20' landward acres c. Total acreage (project site and any contiguous properties) owned or controlled by the applicant or project sponsor? .832 acres							
4. Check all land uses that occur on, adjoining and near the proposed action. <div style="display: flex; flex-wrap: wrap;"> <div style="width: 50%;"> <input type="checkbox"/> Urban <input type="checkbox"/> Rural (non-agriculture) <input type="checkbox"/> Industrial <input type="checkbox"/> Commercial <input checked="" type="checkbox"/> Residential (suburban) </div> <div style="width: 50%;"> <input type="checkbox"/> Forest <input type="checkbox"/> Agriculture <input checked="" type="checkbox"/> Aquatic <input checked="" type="checkbox"/> Other (specify): LZ </div> <div style="width: 50%;"> <input type="checkbox"/> Parkland </div> </div>							

5. Is the proposed action, a. A permitted use under the zoning regulations?	NO <input type="checkbox"/>	YES <input checked="" type="checkbox"/>	N/A <input type="checkbox"/>
b. Consistent with the adopted comprehensive plan?	<input type="checkbox"/>	<input checked="" type="checkbox"/>	<input type="checkbox"/>
6. Is the proposed action consistent with the predominant character of the existing built or natural landscape?	NO <input type="checkbox"/>	YES <input checked="" type="checkbox"/>	
7. Is the site of the proposed action located in, or does it adjoin, a state listed Critical Environmental Area? If Yes, identify: _____	NO <input checked="" type="checkbox"/>	YES <input type="checkbox"/>	
8. a. Will the proposed action result in a substantial increase in traffic above present levels?	NO <input checked="" type="checkbox"/>	YES <input type="checkbox"/>	
b. Are public transportation service(s) available at or near the site of the proposed action?	<input checked="" type="checkbox"/>	<input type="checkbox"/>	
c. Are any pedestrian accommodations or bicycle routes available on or near site of the proposed action?	<input checked="" type="checkbox"/>	<input type="checkbox"/>	
9. Does the proposed action meet or exceed the state energy code requirements? If the proposed action will exceed requirements, describe design features and technologies: _____	NO <input checked="" type="checkbox"/>	YES <input type="checkbox"/>	
10. Will the proposed action connect to an existing public/private water supply? If No, describe method for providing potable water: _____	NO <input checked="" type="checkbox"/>	YES <input type="checkbox"/>	
11. Will the proposed action connect to existing wastewater utilities? If No, describe method for providing wastewater treatment: _____	NO <input checked="" type="checkbox"/>	YES <input type="checkbox"/>	
12. a. Does the site contain a structure that is listed on either the State or National Register of Historic Places?	NO <input checked="" type="checkbox"/>	YES <input type="checkbox"/>	
b. Is the proposed action located in an archeological sensitive area?	<input checked="" type="checkbox"/>	<input type="checkbox"/>	
13. a. Does any portion of the site of the proposed action, or lands adjoining the proposed action, contain wetlands or other waterbodies regulated by a federal, state or local agency?	NO <input type="checkbox"/>	YES <input checked="" type="checkbox"/>	
b. Would the proposed action physically alter, or encroach into, any existing wetland or waterbody? If Yes, identify the wetland or waterbody and extent of alterations in square feet or acres: _____ Located in a littoral zone on Carl's River. Bulkhead will be refaced within 2" and 1.8' higher, replace an open pile pier. Add ramp float, boat lift and mooring piles. Add floats and a ramp in the boat slip. Add a jet ski lift off the bulkhead north of boat slip.	<input type="checkbox"/>	<input checked="" type="checkbox"/>	
14. Identify the typical habitat types that occur on, or are likely to be found on the project site. Check all that apply: <input checked="" type="checkbox"/> Shoreline <input type="checkbox"/> Forest <input type="checkbox"/> Agricultural/grasslands <input type="checkbox"/> Early mid-successional <input type="checkbox"/> Wetland <input type="checkbox"/> Urban <input checked="" type="checkbox"/> Suburban			
15. Does the site of the proposed action contain any species of animal, or associated habitats, listed by the State or Federal government as threatened or endangered?	NO <input checked="" type="checkbox"/>	YES <input type="checkbox"/>	
16. Is the project site located in the 100 year flood plain?	NO <input type="checkbox"/>	YES <input checked="" type="checkbox"/>	
17. Will the proposed action create storm water discharge, either from point or non-point sources? If Yes, a. Will storm water discharges flow to adjacent properties? <input checked="" type="checkbox"/> NO <input type="checkbox"/> YES b. Will storm water discharges be directed to established conveyance systems (runoff and storm drains)? If Yes, briefly describe: <input type="checkbox"/> NO <input checked="" type="checkbox"/> YES The storm water discharge will run off to the drain system on Peninsula Drive _____	<input checked="" type="checkbox"/>	<input type="checkbox"/>	

18. Does the proposed action include construction or other activities that result in the impoundment of water or other liquids (e.g. retention pond, waste lagoon, dam)? If Yes, explain purpose and size: _____	NO	YES
_____	<input checked="" type="checkbox"/>	<input type="checkbox"/>
19. Has the site of the proposed action or an adjoining property been the location of an active or closed solid waste management facility? If Yes, describe: _____	NO	YES
_____	<input checked="" type="checkbox"/>	<input type="checkbox"/>
20. Has the site of the proposed action or an adjoining property been the subject of remediation (ongoing or completed) for hazardous waste? If Yes, describe: _____	NO	YES
_____	<input checked="" type="checkbox"/>	<input type="checkbox"/>
I AFFIRM THAT THE INFORMATION PROVIDED ABOVE IS TRUE AND ACCURATE TO THE BEST OF MY KNOWLEDGE Applicant/sponsor name: <u>Shore Solutions Inc. Donna Myers - President</u> Date: <u>3-30-21</u> Signature: <u>D - Myers</u>		

ENVIRONMENTAL QUESTIONNAIRE

This is intended to supplement ENG Form 4345, Application for Department of the Army Permit, or the Joint Application for Permit used in the State of New York. Please provide complete answers to all questions below which are relevant to your project. Any answers may be continued on separate sheet(s) of paper to be attached to this form.

PRIVACY ACT STATEMENT

The purpose of this form is to provide the Corps of Engineers with basic information regarding your project. This information will be used to facilitate evaluation of your permit application and for public dissemination as required by regulation. Failure to provide complete information may result in your application being declared incomplete for processing, thereby delaying processing of your application.

GENERAL-APPLICABLE TO ALL PROJECTS

1. Explain the need for, and purpose of: the proposed work.

Reface bulkhead to stabilize shoreline. Replace existing pier, add ramp, float, four pile boat lift and mooring piles to provide a safe mooring.

2. Provide the names and addresses of property owners adjacent to your work site (if not shown on the application form or project drawings).

Provided on the site plan.

(Please note that depending upon the nature and extent of your project, you may be requested to provide the names and addresses of additional property owners proximate to your project site to ensure proper coordination.)

3. Photographs of the project site should be submitted. For projects in tidal areas, photographs of the waterway vicinity should be taken at low tide. Using a separate copy of your plan view, indicate the location and direction of each photograph as well as the date and time at which the photograph was taken. Provide a sufficient number of photographs so as to provide a clear understanding of conditions on and proximate to your project site.

Please see photo site page and photo page.

4. Provide a copy of any environmental impact statement, or any other environmental report which was prepared for your project.

Project is covered under Nationwide Permit #3 & #19.
An environmental impact report is not needed.

5. Provide a thorough discussion of alternatives to your proposal. This discussion should include, but not necessarily be limited to, the "no action" alternative and alternative(s) resulting in less disturbance to waters of the United States. For filling projects in waters of the United States, including wetlands, your alternatives discussion should demonstrate that there are no practicable alternatives to your proposed filling and that your project meets with current mitigation policy (i.e. avoidance, minimization and compensation).

Refacing the existing bulkhead will ensure years of function of this erosion control structure. No fill will enter the waterways. Replacing existing pier, adding a ramp, float, four pile boat lift and mooring piles will provide a safe mooring. The mooring configuration will be consistent with the area.

DREDGING PROJECTS

Answer the following if your project involves dredging.

1. Indicate the estimated volume of material to be dredged and the depth (below mean low water) to which dredging would occur. Would there be overdepth dredging?

Dredge up to 25 CY sandy material to a 4' depth below mean low water along the bulkhead to the south of the boat slip and in the boat slip..

No overdepth dredging will occur.

2. You can apply for a ten-year permit for maintenance dredging. If you wish to apply for a ten-year permit, please provide the number of additional dredging events during the ten-year life of the permit and the amount of material to be removed during future events.

3. Indicate on your drawings the dewatering area (if applicable) and disposal site for the dredged material (except landfill sites). Submit a sufficient number of photographs of the dewatering and disposal sites as applicable so as to provide a clear indication of existing conditions. For ten-year maintenance dredging permits, indicate the dewatering/disposal sites for future dredging events, if known.

4. Describe the method of dredging (i.e. clamshell, dragline, etc.) and the expected duration of dredging.

Clam shell bucket dredge for half a day or less.

5. Indicate the physical nature of the material to be dredged (i.e. sand, silt, clay, etc.) and provide estimated percentages of the various constituents if available for beach nourishment projects, grain size analysis data is required.

Existing sandy bottom

6. Describe the method of dredged material containment (i.e. hay bales, embankment, bulkhead, etc.) and whether return flow from the dewatering/disposal site would reenter any waterway. Also indicate if there would be any barge overflow.

All dredge spoil will be contained behind new bulkhead. No return flow will occur. There will be no barge overflow.

MOORING FACILITIES

Answer the following if your project includes the construction or rehabilitation of recreational mooring facilities.

1. It is generally recommended that any fixed piers and walk ramps be limited to four feet in width, and that floats be limited to eight feet in width and rest at least two feet above the waterway bottom at mean low water. Terminal floats at private, noncommercial facilities should be limited to 20 feet in length. If you do not believe your proposal can meet with these recommendations, please provide the reason (s).

Proposed structures meet with your departments recommendations.

2. Using your plan view, show to scale the location (s), position(s) and size(s) (including length, beam and draft) of vessel(s) to be moored at the proposed facility, including those of transient vessel(s) if known.

The owner has a 26' and 38' private recreational vessels. One boat will be moored in the boat slip along the float and the other boat will be on the boat lift seaward of the pier which will provide a safe mooring facility.

3. For commercial mooring sites such as marinas, indicate the capacity of the facility and indicate on the plan view the location(s) of any proposed fueling and/or sewage pumpout facilities. "pumpout facilities" are not planned, please discuss the rationale below and indicate the distance to the nearest available pumpout station.

4. Indicate on your plan view the distance to adjacent marine structures, if any are proximate and show the locations and dimensions of such structures.

On site plan

5. Discuss the need for wave protection at the proposed facility. Please be advised that if a permit is issued, you would be required to recognize that the mooring facility may be subject to wave action from wakes of passing vessels, whose operations would not be required to be modified. Issuance of a permit would not relieve you of ensuring the integrity of the authorized structure(s) and the United States would not be held responsible for damages to the structure(s) and vessel(s) moored thereto from wakes from passing vessels.

This project does not pertain to wave protection.

BULKHEADING/BANK STABILIZATION/FILLING ACTIVITIES

Answer the following If your project includes construction of bulk heading (also retaining walls and seawalls) with backfill, filling of waters/wetlands, or any other bank stabilization fills such as riprap, revetments, gabions, etc.

1. Indicate the total volume of fill (including backfill behind a structure such as a bulkhead) as well as the volume of fill to be placed into waters of the United States. The amount of fill in waters of the United States can be determined by calculating the amount of fill to be placed below the plane of spring high tide in tidal areas and below ordinary high water in non-tidal areas.

The total fill to be placed behind the bulkhead will be up to 150 cubic yards. No fill will be placed below spring tide plane.

2. Indicate the source(s) and type(s) of fill material.

Up to 25 cubic yards sandy dredge spoil.

Truck in 125 CY cubic yards clean fill.

3. Indicate the method of fill placement (i.e. by hand, bulldozer, crane, etc.). Would any temporary fills be required in waterways or wetlands to provide access for construction equipment? If so, please indicate the area of such waters and/or wetlands to be filled, and show on the plan and sectional views.

Place fill behind bulkhead with clam shell bucket, wheelbarrow and hand shovel. No temporary fills will be needed.

Unauthorized alteration or addition to this survey in any way, unless acting under the direction of a Licensed Land Surveyor, is a violation of Section 7209, sub-division 2, of the New York State Education Law.

Copies of this Survey Map not bearing the land surveyor's inked or embossed seal shall not be considered to be a valid true copy.

The offsets or dimensions shown from the foundations to the property lines are for specific purpose and use and therefore are not intended to guide the erection of fences, retaining walls, pools, patios, planting areas, addition to structures and any other construction.

Certifications indicated hereon signify that this survey was prepared in accordance with the existing Code of Practice for Land Surveys adopted by the New York State Association of Professional Land Surveyors. Said certifications shall run only to the person for whom the survey was prepared, and on his behalf to the title company, governmental agency and lending institution listed hereon, and to the successors and/or assignees of the lending institution for the purpose of their mortgage to said person(s) for whom this survey was prepared. Certifications are not transferable to additional institutions or subsequent owners other than above stated.

LOT 93 & P/O LOTS 92 & 94

MAP OF

CARL'S RIVER COLONY
SECTION No. 2

SITUATE

VILLAGE OF BABYLON

TOWN OF BABYLON, SUFFOLK CO., N.Y.

MAP No. 1632, FILED: JUNE 28, 1948

SCTM No., 102-17-2-30 & P/O 31

UPLAND AREA= 31,497.05 SQ.FT. OR 0.7231 AC.

TOTAL AREA= 36,260.6 SQ.FT. OR 0.832 AC.

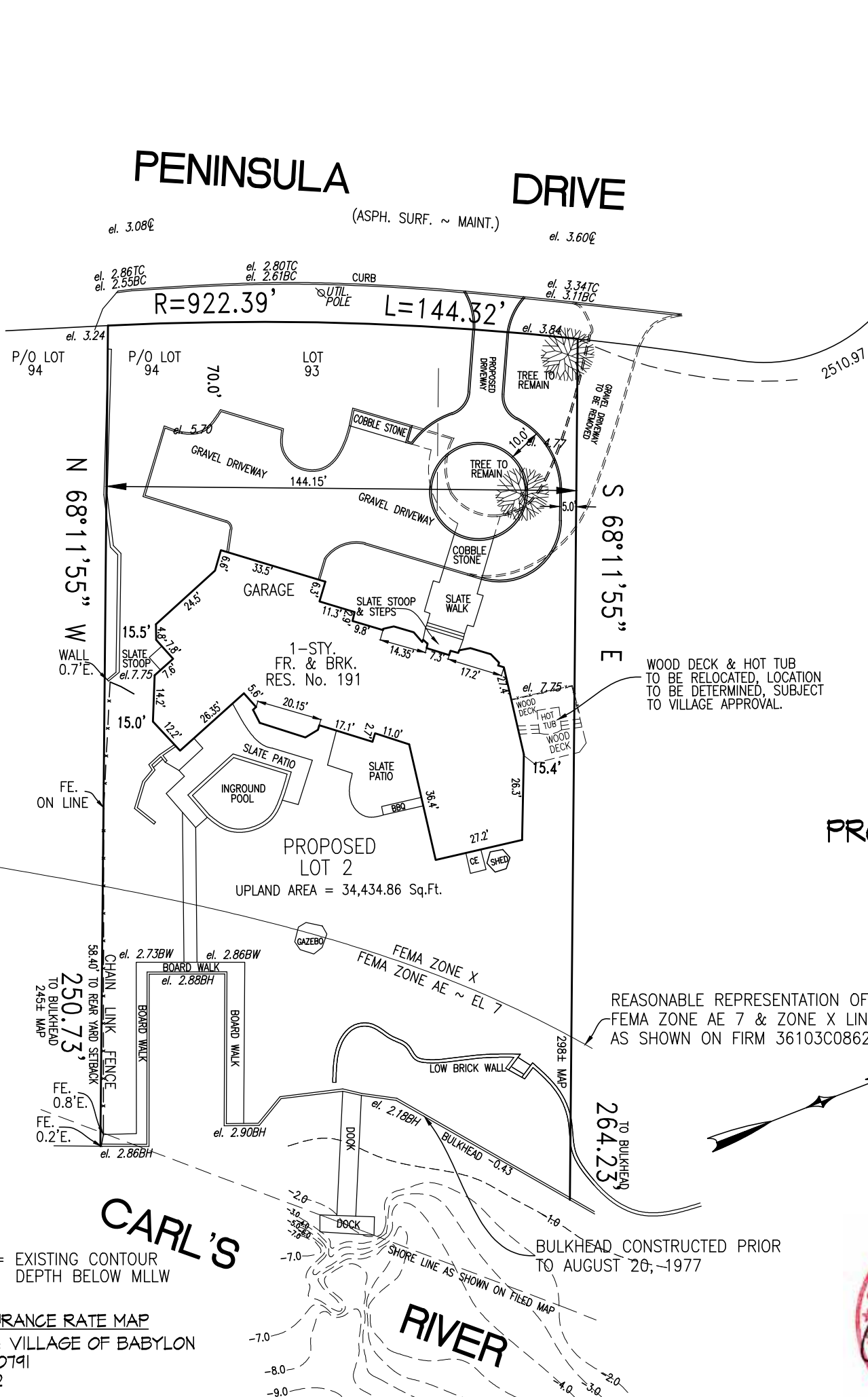

LOT 2
PROPOSED 2-LOT
SUBDIVISION

REASONABLE REPRESENTATION OF
FEMA ZONE AE 7 & ZONE X LINE
AS SHOWN ON FIRM 36103C0862H

FLOOD INSURANCE RATE MAP
COMMUNITY: VILLAGE OF BABYLON
NUMBER: 360791
PANEL: 862
SUFFIX: H
MAP NUMBER: 36103C0862 H
EFFECTIVE DATE: SEPTEMBER 25, 2009
ZONE AE (EL 7)

ADD'L. SOUNDINGS LOT 1: SEP 1, 2020
REVISED PLAN: JUN 6, 2020
REVISED PLAN: MAY 6, 2020
ADDED SOUNDINGS: AUG 12, 2019
UPDATE SURVEY: MAY 22, 2019
SURVEYED: MAY 26, 2017
SCALE: 1" = 40'

SOUNDINGS BY:
LISA McQUILKIN LAND SURVEYOR
ON JULY 8, 2019
LOW TIDE AT 10:00AM
HIGH TIDE AT 3:46PM



CRAIG M. LEHAT, P.E., P.L.S.

NEW YORK STATE LICENSED
PROFESSIONAL ENGINEER
AND

PROFESSIONAL LAND SURVEYOR

52 KEMI LANE, SAYVILLE, NY 11782-1150

PH/FAX (631) 472-5368

WWW.CRAIGMLEHATPEPLS.COM

FILE No 23143-S-2

191 Peninsula Dr Babylon NY

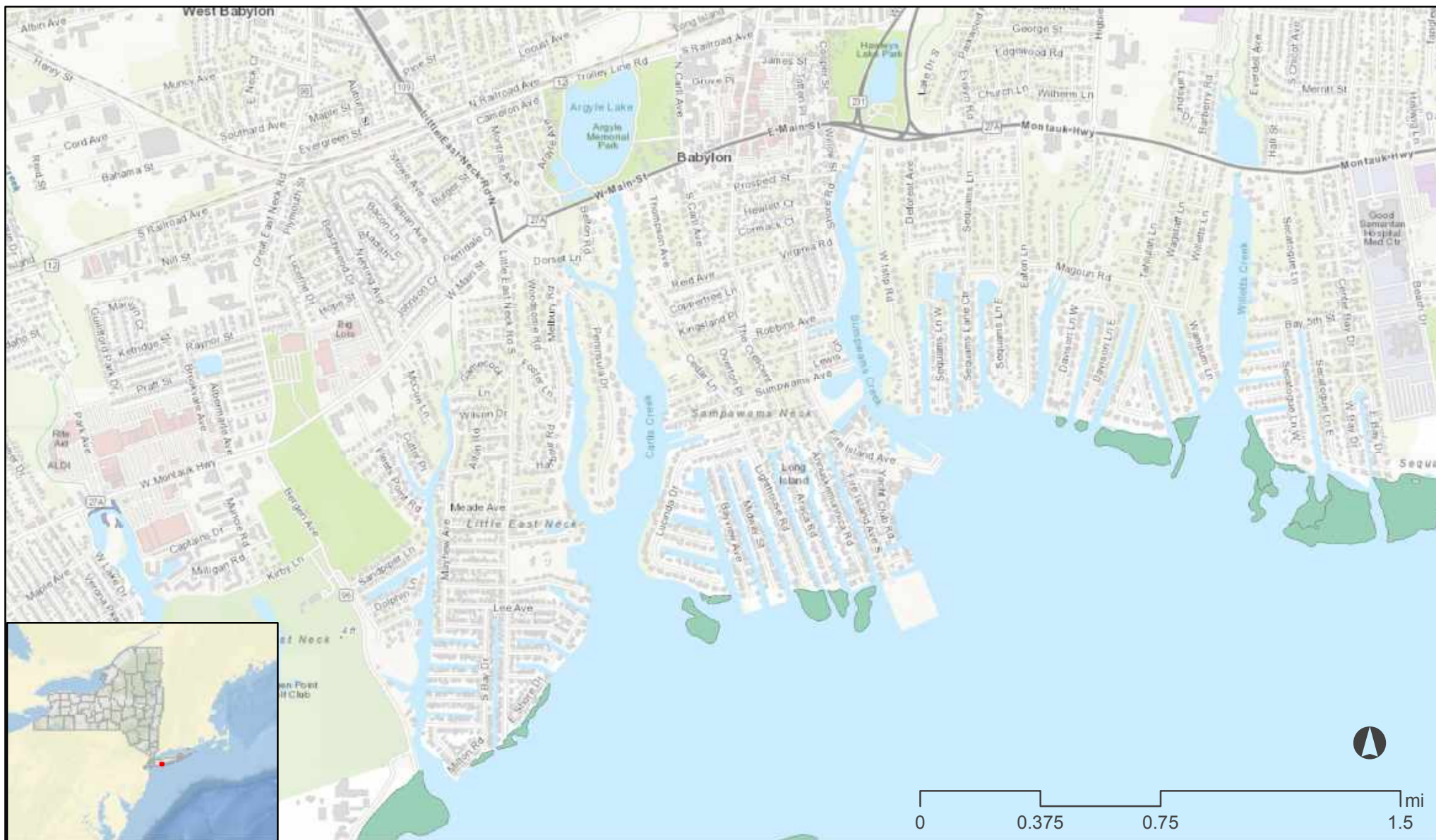









- | | | | | | | | |
|--|-----------------------------|---|----------------------|---|---------------------------------------|---|---------------------------------------|
|  | Marine Mammals Habitat |  | Benthic Macroalgae |  | Mollusk Reef Biota |  | Long Island South Shore Seagrass 2018 |
|  | Aquatic Vascular Vegetation |  | Emergent Tidal Marsh |  | Long Island South Shore Seagrass 2002 |  | Eelgrass Beds |

PHOTO SITES

PHOTOS TAKEN 10/9/2021 @11:00 AM

- WATER DEPTHS TAKEN FROM LISA MCQUILKIN LAND SURVEYOR DATED 7/8/2019
- #'S REPRESENT DEPTHS BELOW MLLW AS PER NOAA V-DATUM TOOL VERSION 3.4
- ALL DIMENSIONS, SETBACKS AND ELEVATIONS TAKEN FROM SURVEY
- BY CRAIG M. LEHAT, P.E., PLS DATED 6/6/2020

ADJACENT PROPERTY OWNER:
PENINSULA BABYLON LLC PROPERTY
189 PENINSULA DRIVE

NO MARINE STRUCTURES
ON ADJACENT PROPERTY
277' TO ADJACENT PIER

EXISTING 254 LF BULKHEAD WITHIN 2'
(63', 11', 6', 18', 10', 10', 45', 23', 53' & 15' SEC.)
MLW/MHW/SHW/TWB @ BH

SHORELINE AS PER FILED MAP

DISTANCE OF WATERWAY ~ 500'
SEAWARD DISTANCE OF MARINE STRUCTURES = 74' 7"

EXISTING 6' X 36' PIER WITH 6' X 17' "T" END

CARL'S RIVER
FLOOD
EBB

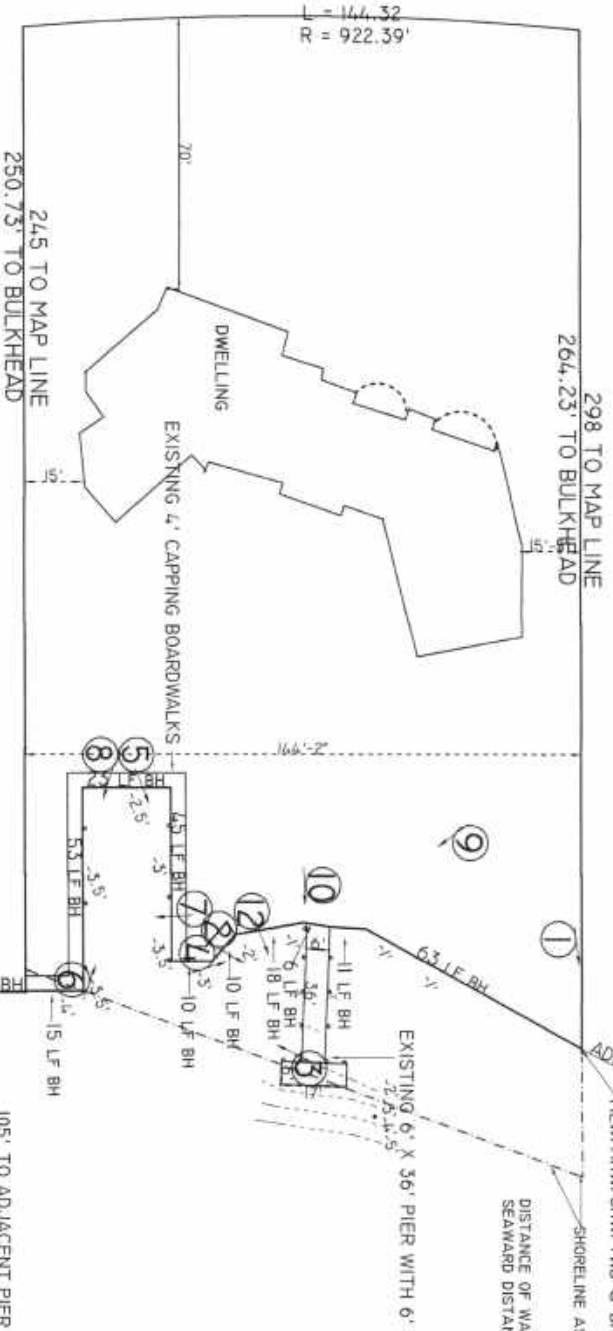

ADJACENT PROPERTY OWNER:
JOSEPH J. TYMINSKI RESIDENCE
195 PENINSULA DRIVE

- TIDAL LINES DOCUMENTED & TIDAL WETLAND
BOUNDARY DELINEATED @ MHW - 1:20 PM
8/28/2020 BY DONNA MYERS / SHORE SOLUTIONS INC.

PURPOSE: BULKHEAD REPAIR AND MAINTENANCE / MINOR DREDGING / REPLACE FIXED "T" PIER, ADD FLOATS &
LIFT TO ACCESS NAVIGABLE WATER FOR A SAFE PRIVATE MOORING FACILITY

SCTM# SD 102 / SEC 17 /
BLK 2 / LOT 30 & P/O LOT 31
AT: 191 PENINSULA DRIVE
BABYLON, NY 11702
VILLAGE OF BABYLON
SUFFOLK COUNTY

SHW= 0.6325'
MHW= 0.4615'
DATUM = 0.0'
MLW= -0.6678'
MLLW= -0.7531'

LAT 40° 41' 7.1478 " N
LONG -73° 19' 43.6866 " W

SCALE 1" = 50'

PREPARED BY
SHORE SOLUTIONS INC.

ON: CARL'S RIVER
FOR: PENINSULA BABYLON LLC
JOSEPH JOHNS - PRESIDENT

PHOTO PAGE 1 OF 4

PHOTO #1 LOOKING AT NORTH CORNER



PHOTO #2 LOOKING NORTH AT EXISTING PIER



PHOTO #3 LOOKING SOUTHWEST



PHOTO #4 LOOKING NORTH

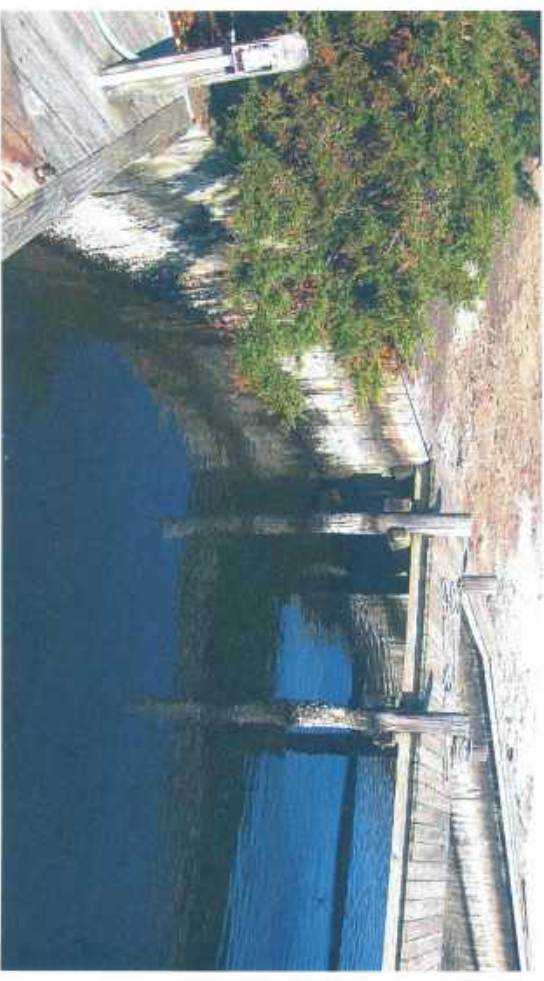

PHOTO #5 LOOKING AT NORTH SIDE OF BOAT SLIP



PHOTO #6 LOOKING AT BACK OF BOAT SLIP



PHOTO #7 LOOKING AT SOUTH CORNER
& SOUTH SIDE OF BOAT SLIP



PHOTO #8 LOOKING AT SOUTH SIDE OF BOAT SLIP



PHOTO #9 LOOKING SOUTH AT PIER



PHOTO #10 LOOKING EAST AT PIER



PHOTO #11 LOOKING SOUTH



PHOTO #12 LOOKING EAST AT PIER

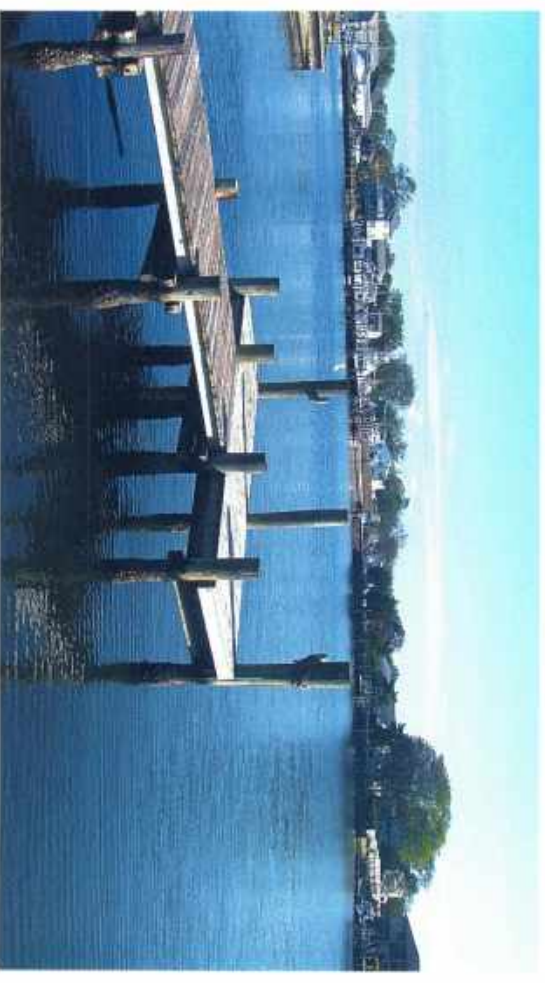



TIDAL WETLAND MAP # 640-504
INDEX MAP #2
Dated August 10 thru October 9 1974

SITE

For: Peninsula Babylon LLC
Joseph Johns, President
191 Peninsula Drive
Babylon, NY 11702

This map was prepared by the New York State Department of Environmental Conservation, Division of Fish and Wildlife, under contract to the New York State Department of Environmental Conservation.

TIDAL WETLAND MAP
NEW YORK STATE DEPARTMENT OF ENVIRONMENTAL CONSERVATION
MAP 640-504

INDEX MAP NUMBER 2
COPIES OF THIS MAP (LARGE SCALE AND SMALL SCALE) ARE AVAILABLE FROM THE NEW YORK STATE DEPARTMENT OF ENVIRONMENTAL CONSERVATION, DIVISION OF FISH AND WILDLIFE, 625 ROUTE 9W, SUITE 100, GAITHERSBURG, NY 12520. (518) 537-1100.

SCALE 1:2400



LEGEND

POLITICAL JURISDICTIONS		WETLAND CATEGORIES	
State	County of Suffolk	01	Intertidal
County	County of Suffolk	02	Submerged
Town or City	Town of Babylon	03	Emergent Freshwater
Neighborhood	Neighborhood of Babylon	04	Emergent Brackish
		05	Emergent Saltwater
		06	Emergent
		07	Emergent
		08	Emergent
		09	Emergent
		10	Emergent
		11	Emergent
		12	Emergent
		13	Emergent
		14	Emergent
		15	Emergent
		16	Emergent
		17	Emergent
		18	Emergent
		19	Emergent
		20	Emergent
		21	Emergent
		22	Emergent
		23	Emergent
		24	Emergent
		25	Emergent
		26	Emergent
		27	Emergent
		28	Emergent
		29	Emergent
		30	Emergent
		31	Emergent
		32	Emergent
		33	Emergent
		34	Emergent
		35	Emergent
		36	Emergent
		37	Emergent
		38	Emergent
		39	Emergent
		40	Emergent
		41	Emergent
		42	Emergent
		43	Emergent
		44	Emergent
		45	Emergent
		46	Emergent
		47	Emergent
		48	Emergent
		49	Emergent
		50	Emergent
		51	Emergent
		52	Emergent
		53	Emergent
		54	Emergent
		55	Emergent
		56	Emergent
		57	Emergent
		58	Emergent
		59	Emergent
		60	Emergent
		61	Emergent
		62	Emergent
		63	Emergent
		64	Emergent
		65	Emergent
		66	Emergent
		67	Emergent
		68	Emergent
		69	Emergent
		70	Emergent
		71	Emergent
		72	Emergent
		73	Emergent
		74	Emergent
		75	Emergent
		76	Emergent
		77	Emergent
		78	Emergent
		79	Emergent
		80	Emergent
		81	Emergent
		82	Emergent
		83	Emergent
		84	Emergent
		85	Emergent
		86	Emergent
		87	Emergent
		88	Emergent
		89	Emergent
		90	Emergent
		91	Emergent
		92	Emergent
		93	Emergent
		94	Emergent
		95	Emergent
		96	Emergent
		97	Emergent
		98	Emergent
		99	Emergent
		100	Emergent

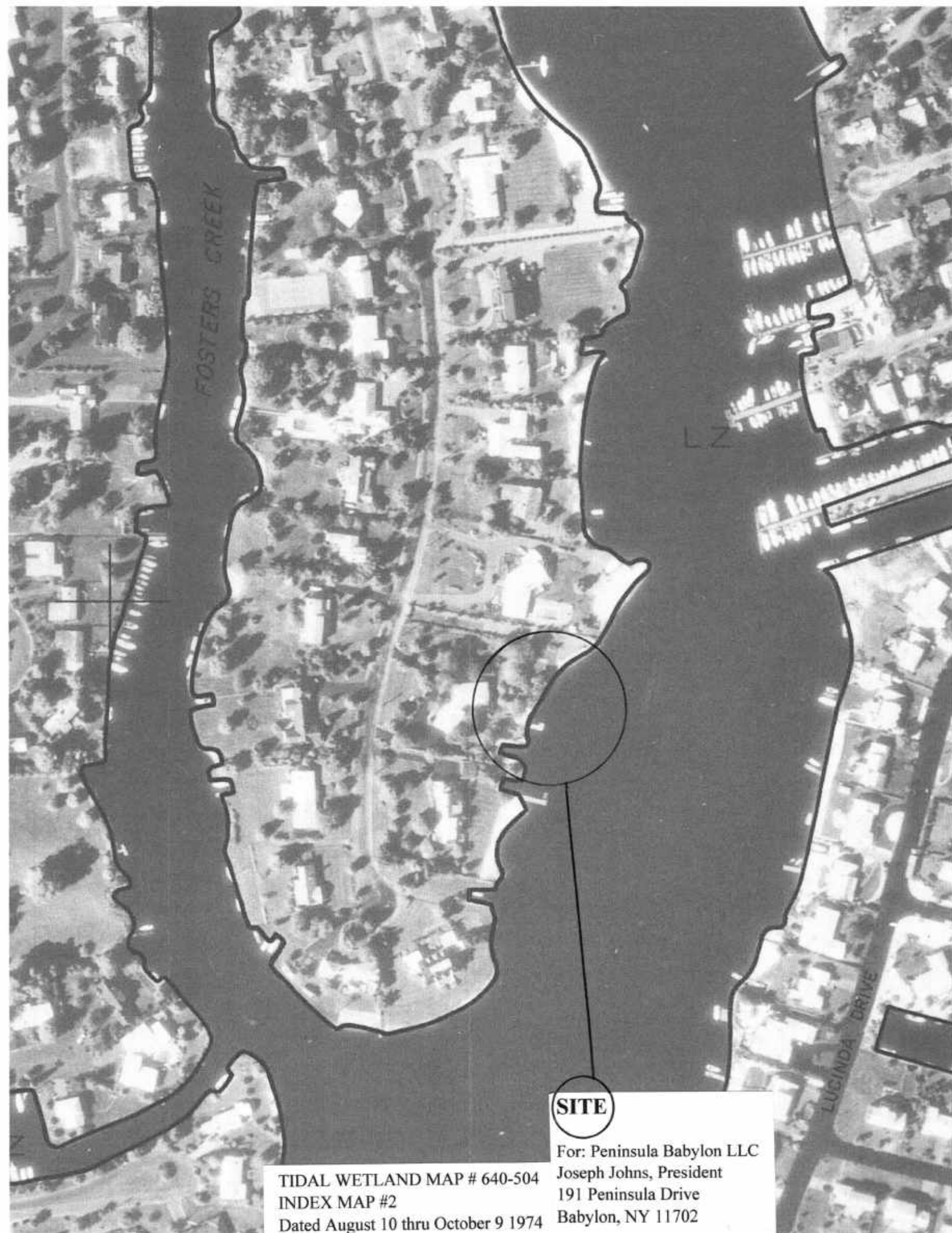

FOSTERS CREEK

LZ

LUCINDA DRIVE

SITE

TIDAL WETLAND MAP # 640-504
INDEX MAP #2
Dated August 10 thru October 9 1974

For: Peninsula Babylon LLC
Joseph Johns, President
191 Peninsula Drive
Babylon, NY 11702