

Short Environmental Assessment Form Part 1 - Project Information

Instructions for Completing

Part 1 – Project Information. The applicant or project sponsor is responsible for the completion of Part 1. Responses become part of the application for approval or funding, are subject to public review, and may be subject to further verification. Complete Part 1 based on information currently available. If additional research or investigation would be needed to fully respond to any item, please answer as thoroughly as possible based on current information.

Complete all items in Part 1. You may also provide any additional information which you believe will be needed by or useful to the lead agency; attach additional pages as necessary to supplement any item.

Part 1 – Project and Sponsor Information			
Name of Action or Project: Rebuild a dock on the St. Lawrence River, that the 2003 ice storm took out			
Project Location (describe, and attach a location map): 16961 Blanchard Ln W Clayton N.Y. The dock will be in the St. Lawrence River.			
Brief Description of Proposed Action: I want to build a crib dock the same length and size as all my neighbor's. In the middle of the property a 6 foot by 70 foot dock will be built. It will be made of wood and rock. Four, 6 foot by 6 foot rock filled cribs. The dock will start with a 6 foot by 16 foot catwalk starting at the sea wall. The first crib will be at the 16 feet out from the sea wall. The other 3 cribs will be every 10 feet, for a total of 4 for the 70 feet. The 8 inch and larger rock will be brought in from a gravel yard, to be placed in the crib. There will be minimum amount of wood from the sides of the dock touching the water.			
Name of Applicant or Sponsor: James D Kirchberger		Telephone: 520-271-4326 E-Mail: jimkirchberger@gmail.com	
Address: 4220 N. Homestead Ave			
City/PO: Tucson		State: AZ	Zip Code: 85749
1. Does the proposed action only involve the legislative adoption of a plan, local law, ordinance, administrative rule, or regulation? If Yes, attach a narrative description of the intent of the proposed action and the environmental resources that may be affected in the municipality and proceed to Part 2. If no, continue to question 2.			NO <input type="checkbox"/> YES <input checked="" type="checkbox"/>
2. Does the proposed action require a permit, approval or funding from any other government Agency? If Yes, list agency(s) name and permit or approval: Town of Clayton, Army corp of engineers, NY coastal, DEC,			NO <input type="checkbox"/> YES <input checked="" type="checkbox"/>
3. a. Total acreage of the site of the proposed action?		.0037 acres	
b. Total acreage to be physically disturbed?		.0098 acres	
c. Total acreage (project site and any contiguous properties) owned or controlled by the applicant or project sponsor?		.17 acres	
4. Check all land uses that occur on, are adjoining or near the proposed action:			
5. <input type="checkbox"/> Urban <input checked="" type="checkbox"/> Rural (non-agriculture) <input type="checkbox"/> Industrial <input type="checkbox"/> Commercial <input checked="" type="checkbox"/> Residential (suburban)			
<input type="checkbox"/> Forest <input type="checkbox"/> Agriculture <input checked="" type="checkbox"/> Aquatic <input type="checkbox"/> Other(Specify):			
<input type="checkbox"/> Parkland			

5. Is the proposed action,	NO	YES	N/A
a. A permitted use under the zoning regulations?	<input checked="" type="checkbox"/>	<input type="checkbox"/>	<input type="checkbox"/>
b. Consistent with the adopted comprehensive plan?	<input checked="" type="checkbox"/>	<input type="checkbox"/>	<input type="checkbox"/>
6. Is the proposed action consistent with the predominant character of the existing built or natural landscape?	NO	YES	
	<input checked="" type="checkbox"/>	<input type="checkbox"/>	
7. Is the site of the proposed action located in, or does it adjoin, a state listed Critical Environmental Area?	NO	YES	
If Yes, identify: _____	<input checked="" type="checkbox"/>	<input type="checkbox"/>	
8. a. Will the proposed action result in a substantial increase in traffic above present levels?	NO	YES	
b. Are public transportation services available at or near the site of the proposed action?	<input checked="" type="checkbox"/>	<input type="checkbox"/>	
c. Are any pedestrian accommodations or bicycle routes available on or near the site of the proposed action?	<input checked="" type="checkbox"/>	<input type="checkbox"/>	
9. Does the proposed action meet or exceed the state energy code requirements?	NO	YES	
If the proposed action will exceed requirements, describe design features and technologies: _____ _____	<input checked="" type="checkbox"/>	<input type="checkbox"/>	
10. Will the proposed action connect to an existing public/private water supply?	NO	YES	
If No, describe method for providing potable water: _____ _____	<input type="checkbox"/>	<input checked="" type="checkbox"/>	
11. Will the proposed action connect to existing wastewater utilities?	NO	YES	
If No, describe method for providing wastewater treatment: _____ N/A The house has a wastewater system	<input checked="" type="checkbox"/>	<input type="checkbox"/>	
12. a. Does the project site contain, or is it substantially contiguous to, a building, archaeological site, or district which is listed on the National or State Register of Historic Places, or that has been determined by the Commissioner of the NYS Office of Parks, Recreation and Historic Preservation to be eligible for listing on the State Register of Historic Places?	NO	YES	
	<input checked="" type="checkbox"/>	<input type="checkbox"/>	
b. Is the project site, or any portion of it, located in or adjacent to an area designated as sensitive for archaeological sites on the NY State Historic Preservation Office (SHPO) archaeological site inventory?	<input checked="" type="checkbox"/>	<input type="checkbox"/>	
13. a. Does any portion of the site of the proposed action, or lands adjoining the proposed action, contain wetlands or other waterbodies regulated by a federal, state or local agency?	NO	YES	
	<input type="checkbox"/>	<input checked="" type="checkbox"/>	
b. Would the proposed action physically alter, or encroach into, any existing wetland or waterbody?	<input type="checkbox"/>	<input checked="" type="checkbox"/>	
If Yes, identify the wetland or waterbody and extent of alterations in square feet or acres: _____ Four cribs , 6 foot by 6 foot , that will hold 6 inch rocks or larger. A total of 162 square feet. _____ _____			

14. Identify the typical habitat types that occur on, or are likely to be found on the project site. Check all that apply:		
<input checked="" type="checkbox"/> Shoreline <input type="checkbox"/> Forest <input type="checkbox"/> Agricultural/grasslands <input type="checkbox"/> Early mid-successional <input type="checkbox"/> Wetland <input type="checkbox"/> Urban <input checked="" type="checkbox"/> Suburban		
15. Does the site of the proposed action contain any species of animal, or associated habitats, listed by the State or Federal government as threatened or endangered?	NO	YES
	<input checked="" type="checkbox"/>	<input type="checkbox"/>
16. Is the project site located in the 100-year flood plan?	NO	YES
	<input checked="" type="checkbox"/>	<input type="checkbox"/>
17. Will the proposed action create storm water discharge, either from point or non-point sources?	NO	YES
If Yes,	<input checked="" type="checkbox"/>	<input type="checkbox"/>
a. Will storm water discharges flow to adjacent properties?	<input checked="" type="checkbox"/>	<input type="checkbox"/>
b. Will storm water discharges be directed to established conveyance systems (runoff and storm drains)?	<input checked="" type="checkbox"/>	<input type="checkbox"/>
If Yes, briefly describe:		

18. Does the proposed action include construction or other activities that would result in the impoundment of water or other liquids (e.g., retention pond, waste lagoon, dam)?	NO	YES
If Yes, explain the purpose and size of the impoundment:	<input checked="" type="checkbox"/>	<input type="checkbox"/>

19. Has the site of the proposed action or an adjoining property been the location of an active or closed solid waste management facility?	NO	YES
If Yes, describe:	<input checked="" type="checkbox"/>	<input type="checkbox"/>

20. Has the site of the proposed action or an adjoining property been the subject of remediation (ongoing or completed) for hazardous waste?	NO	YES
If Yes, describe:	<input checked="" type="checkbox"/>	<input type="checkbox"/>

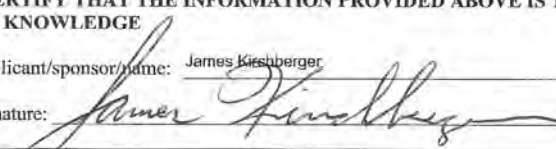
I CERTIFY THAT THE INFORMATION PROVIDED ABOVE IS TRUE AND ACCURATE TO THE BEST OF MY KNOWLEDGE		
Applicant/sponsor/name: James Kirschberger	Date: 4/18/2023	
Signature: 	Title: _____	

PRINT FORM

Scanned from my iPad

From: [redacted]
To: [redacted]
Subject: [redacted]
Date: Monday, April 24, 2023 9:51:10 AM

[You don't often get email from jankinb@erpc.com. Learn why this is important at <https://aka.ms/LearnAboutSenderIdentification>]

ATTENTION: This email came from an external source. Do not open attachments or click on links from unknown senders or unexpected emails.

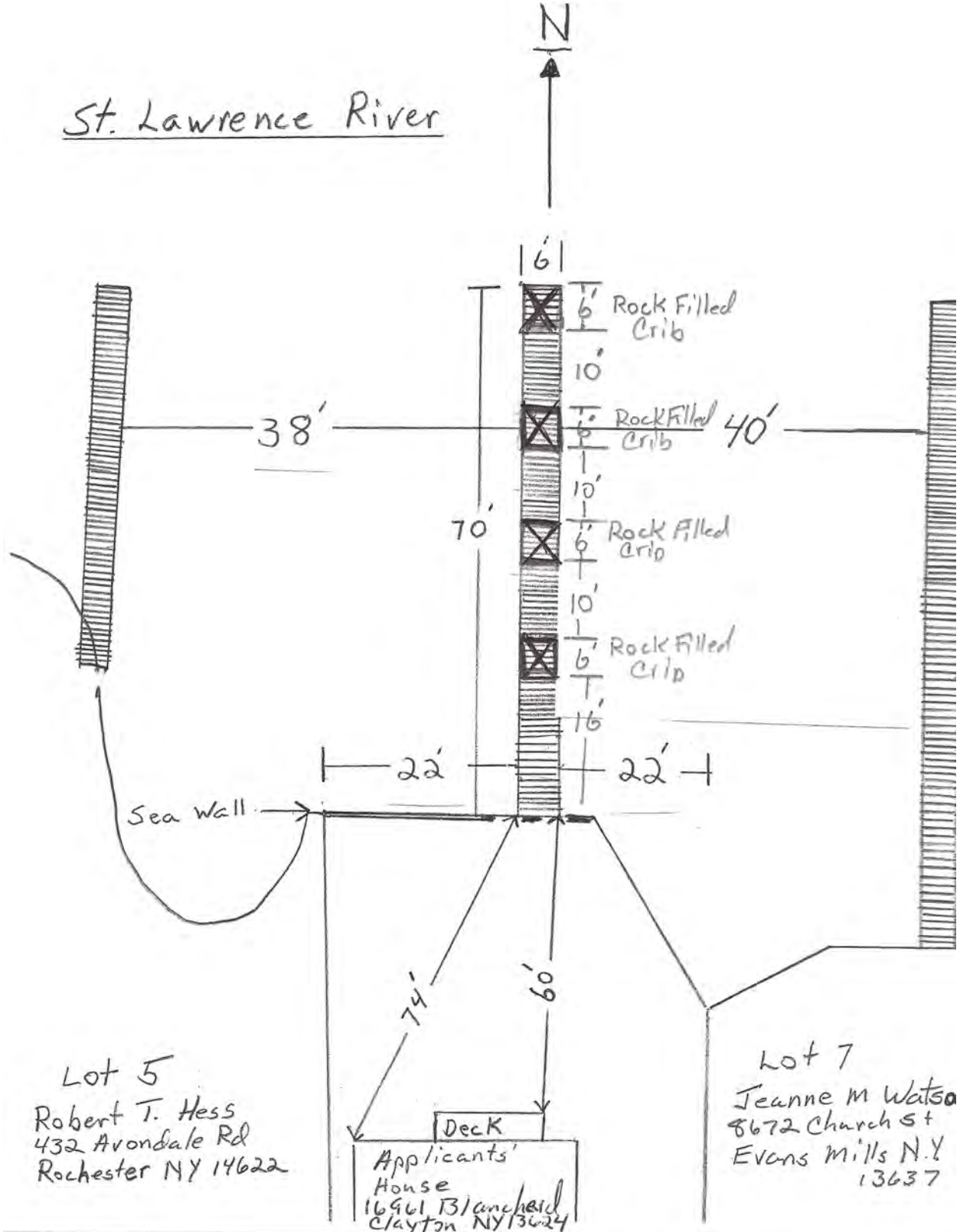

St. Lawrence River

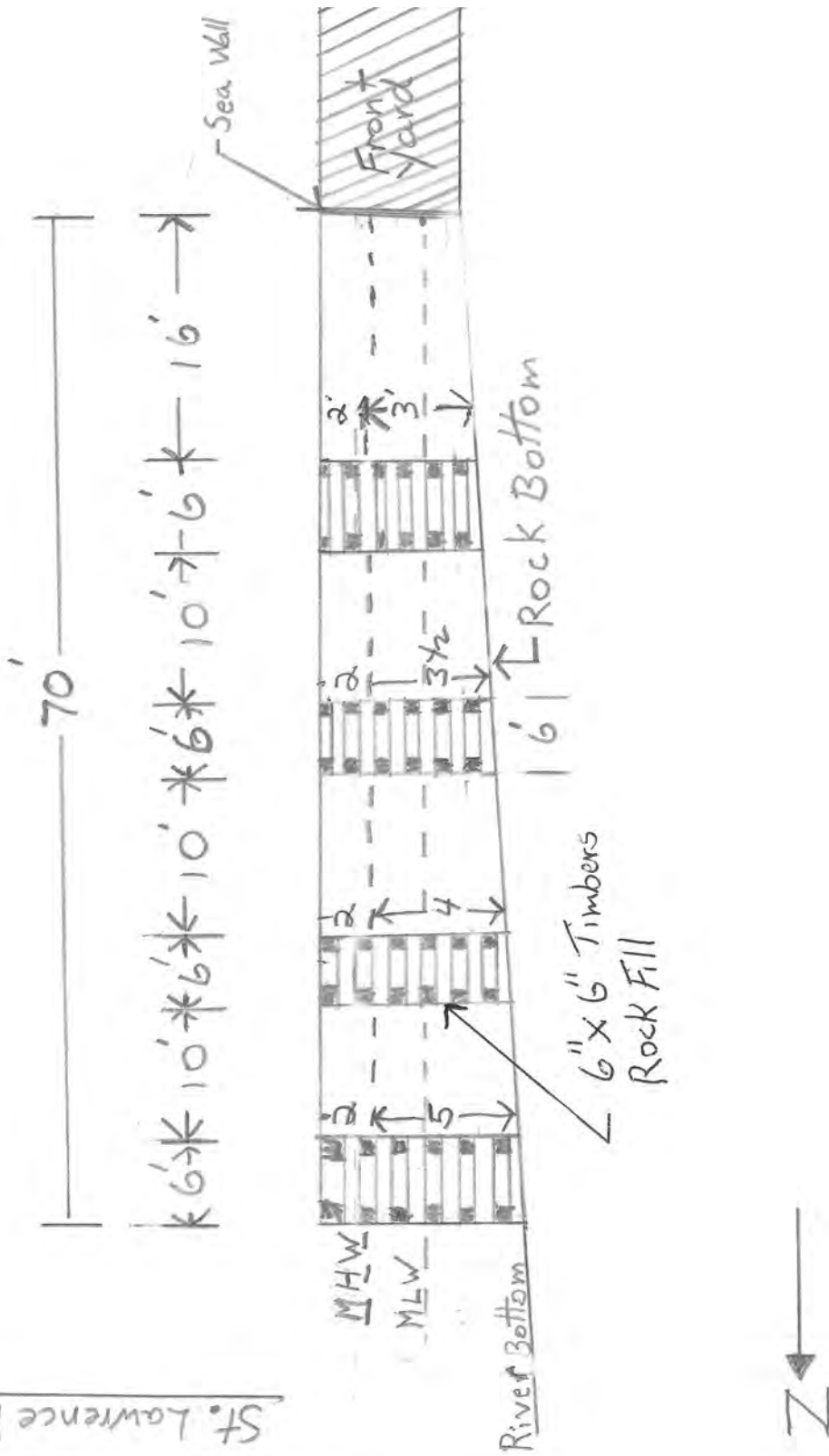

James Kirchberger
16961 Blanchard Rd
Clayton N.Y. 13624

Site Plan

Scale
1" = 25'
N ↑

